



Connells

Cheere Way
Papworth Everard

Cheere Way,
Papworth Everard, CB23 3NX

For Sale Guide Price
£325,000 - £335,000



Set in a village location lies this popular style townhouse - boasting kitchen, dining room and lounge, further offering three bedrooms including the top floor suite with walk in wardrobe and ensuite. Outside presents a courtyard garden, garage and parking.

Entrance Hall

Door to front, tiled flooring, telephone point.

Cloakroom

Wash hand basin, WC, extractor fan, radiator, restricted head height.

Lounge

Bay window to front, telephone point, radiator.

Inner Hall

Stairs to first landing, storage cupboard.

Kitchen

Window to rear, refitted kitchen with a range of wall and base units, complementary work surface, sink with one and a half bowl and drainer, tiled splash back, electric oven, five burner gas hob, cooker hood, plumbing for washing machine and dishwasher, space for fridge/freezer, central heating boiler, arch to dining area.

Dining Room

French door to rear, radiator.

First Floor Landing

Stairs to inner hall and second floor landing, radiator.



Bedroom Two

Two windows to front, double built in wardrobe, two radiators.

Bedroom Three

Two windows to rear, airing cupboard, double built in wardrobes, two radiators.

Bathroom

Bath with mixer tap and shower over, wash hand basin, WC, extractor fan, shaver point, tiled flooring, part tiled, radiator.

Second Floor Landing

Stairs to first floor landing.

Bedroom One

Window to front, loft access, television point, restricted head height.

Walk In Wardrobe

Shelf and hanging space, restricted head height.

Ensuite

Velux to rear, shower cubicle, wash hand basin, WC, mirror with light unit, radiator, restricted head height.

Front Garden

Light , path to door.

Rear Garden

Fence enclosed, paved garden, hedges, personnel door, outside tap, gate to rear.

Garage And Parking

Single garage with up and over door, door to garden, light and power, one allocated parking space.

Agent Notes

Please ask regarding charge.







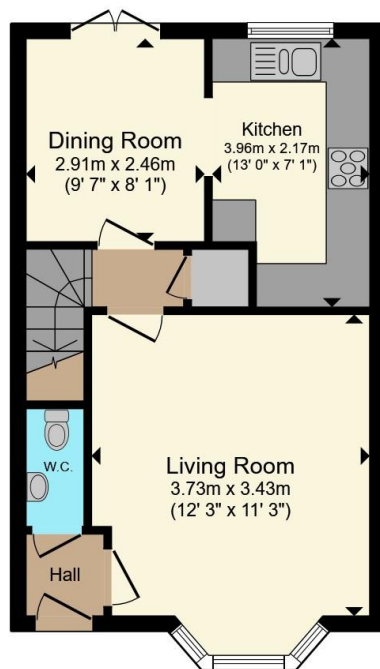

Ground Floor

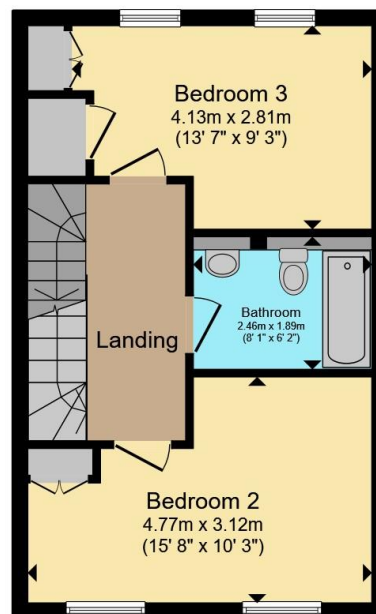

First Floor



Second Floor

Total floor area 104.3 m² (1,123 sq.ft.) approx

This floor plan is for illustrative purposes only. It is not drawn to scale. Any measurements, floor areas (including any total floor area), openings and orientation are approximate. No details are guaranteed, they cannot be relied upon for any purpose and they do not form part of any agreement. No liability is taken for any error, omission or misstatement. A party must rely upon its own inspection(s). Powered by www.propertybox.io

Connells

To view this property please contact Connells on

T 01954 714900
E cambourne@connells.co.uk

Unit 2 Caxton House Broad Street Great Cambourne
CAMBRIDGE CB23 6JN

EPC Rating: C Council Tax
Band: D

Tenure: Freehold

view this property online connells.co.uk/Property/CBN306554



1. MONEY LAUNDERING REGULATIONS Intending purchasers will be asked to produce identification documentation at a later stage and we would ask for your co-operation in order that there will be no delay in agreeing the sale. 2. These particulars do not constitute part or all of an offer or contract. 3. The measurements indicated are supplied for guidance only and as such must be considered incorrect. Potential buyers are advised to recheck measurements before committing to any expense. 4. We have not tested any apparatus, equipment, fixtures, fittings or services and it is in the buyers interest to check the working condition of any appliances.

Connells Residential is registered in England and Wales under company number 1489613, Registered Office is Cumbria House, 16-20 Hockliffe Street, Leighton Buzzard, Bedfordshire, LU7 1GN. VAT Registration Number is 500 2481 05.

See all our properties at www.connells.co.uk | www.rightmove.co.uk | www.zoopla.co.uk

Property Ref: CBN306554 - 0002