



MILE



Brondesbury Villas, London NW6

£625,000 Leasehold

Welcome to Brondesbury Villas. Set on a peaceful, tree-lined street just moments from Queen's Park station, this impressive three-bedroom apartment occupies the raised ground floor of a handsome period building. Offering approximately 796 sq ft of beautifully presented living space, the property features a bright south-facing open-plan kitchen and reception room with bay window, three well-sized bedrooms, a stylish family bathroom, separate shower room, and a convenient guest WC. Ideally located off Salusbury Road, you're just a short stroll from the vibrant cafes, boutiques and eateries of both Salusbury and Lonsdale Roads. Excellent transport links are close by, including Queen's Park (Bakerloo & Overground) and Brondesbury Park (Overground), ensuring swift access across London. A wonderful home in a sought-after neighbourhood.

- Raised ground floor
- Three bedrooms
- Two bathrooms
- Chain free
- Excellent condition
- 796 sq ft
- Great location
- 105 year lease
- Flexible layout
- Close to shops and transports

BRONDES BURY VILLAS, NW6

Approximate Gross Internal Area = 73.93 sq.m / 796 sq.ft

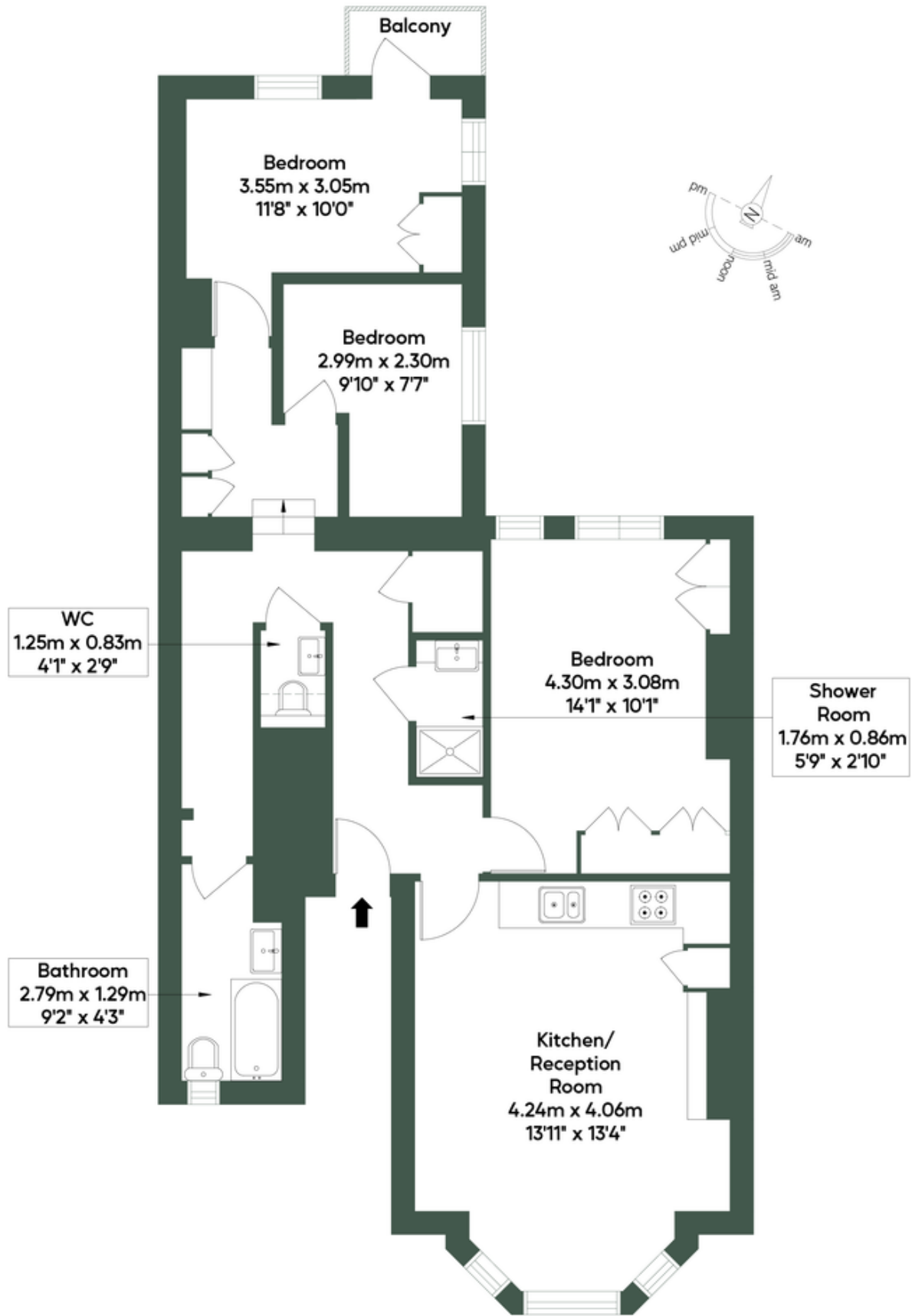

Raised Ground Floor



MONEY LAUNDERING REGULATIONS 2003: Intending purchasers will be asked to produce identification documentation at a later stage and we would ask for your co-operation in order that there will be no delay in agreeing the sale.

General: While we endeavour to make our sales particulars fair, accurate and reliable, they are only a general guide to the property and, accordingly, if there is any point which is of particular importance to you, please contact the office and we will be pleased to check the position for you, especially if you are contemplating travelling some distance to view the property.

Measurements: These approximate room sizes are only intended as general guidance. You must verify the dimensions carefully before ordering carpets or any built-in furniture.

Services: Please note we have not tested the services or any of the equipment or appliances in this property, accordingly we strongly advise prospective buyers to commission their own survey or service reports before finalising their offer to purchase.