



Keith  
Ashton

Green Lane, Pilgrims Hatch  
Brentwood



GROUND FLOOR  
405 sq.ft. (37.6 sq.m.) approx.

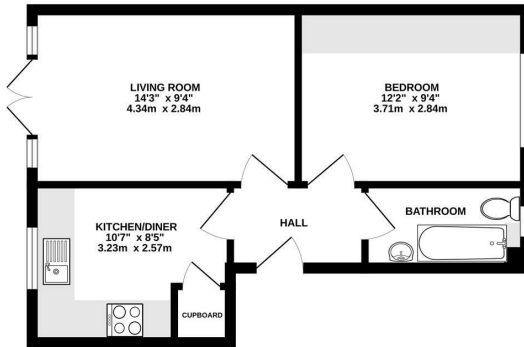

TOTAL FLOOR AREA: 405 sq ft. (37.6 sq.m.) approx.  
Measurements are approximate. Not to scale. Dimensions given are only those with which we are aware.

Guide Price £210,000



## Flat 2, Meadowview Green Lane, Pilgrims Hatch, Brentwood, CM15 9RR

**\*\*Guide Price £210,000 - £220,000\*\*** We are pleased to present this ground floor garden apartment, ideally located in the popular area of Pilgrims Hatch. Just a short drive from Brentwood High Street, the property benefits from close proximity to a good selection of shops, cafés, bars, and restaurants.

Inside, the apartment offers a thoughtfully designed layout featuring a well-equipped kitchen, a spacious living room with French doors opening onto the rear garden, a generous double bedroom, and a bathroom fitted with a classic white suite. Outside, the private garden is a true highlight—well-tended with mature planting, it provides a peaceful and secluded space to relax. Residents also enjoy access to additional communal gardens and the convenience of on-site parking. Please note the Catio in the garden will be removed.

Located just 1.6 miles from Brentwood Station, with excellent rail links into London and beyond, this property combines comfort, convenience, and excellent connectivity.

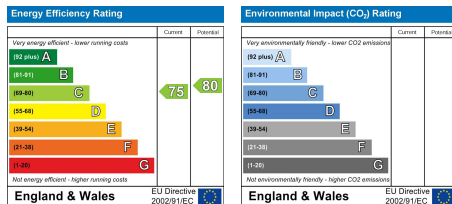

### SERVICES:

Local Authority: Brentwood  
Council tax band: B  
Post code: CM15 9RR

### VIEWING:

Strictly by prior arrangement with Keith Ashton Estate Agents

### OPENING HOURS:

Monday to Friday: 8.45AM - 6.30PM | Saturdays: 9AM - 5.30PM | Sundays: 10AM - 2PM

### MORTGAGE INFORMATION:

We offer the additional facility of an in-house Independent Financial Adviser who will access all mortgage lenders with the purpose of providing you with the benefit of choice. For quotations or comparables please call 01277 260858 or visit our interactive website at [www.mortgagebusiness.net](http://www.mortgagebusiness.net)



We the Agent have not tested any apparatus, fittings or services for this property. The plot size is intended merely as a guide and has not been officially measured or verified by the Agent. Photographs are for illustration only and may depict items which are not for sale or included in the sale of the property. As part of the service we offer we may recommend ancillary services to you which we believe may help you with your property transaction. We wish to make you aware, that should you decide to use these services we will receive a referral fee. For full and detailed information please visit 'terms and conditions' on our website [www.keithashton.co.uk](http://www.keithashton.co.uk)

Brentwood  
Tel. 01277 260858

Village Office  
Tel. 01277 375757

Lettings Office  
Tel. 01277 202200

Explore more @ [www.keithashton.co.uk](http://www.keithashton.co.uk)

