



Chepstow Crescent, W11

£650,000

A beautifully refurbished two bedroom apartment located in a Victorian building in prime Notting Hill. The apartment has an open plan kitchen/reception area with room to dine and amazing views, wooden flooring, and a modern bathroom.

Chepstow Crescent is an attractive tree-lined street, situated between Chepstow Villas and Pembridge Villas. It is close to all the amenities of Notting Hill Gate, Westbourne Grove and Portobello Road.

Features

- OIEO
- Share Of Freehold
- Two Bedrooms
- Victorian Conversion
- Tree-Lined Street
- Wooden Flooring
- Notting Hill

Chepstow Crescent, London, W11

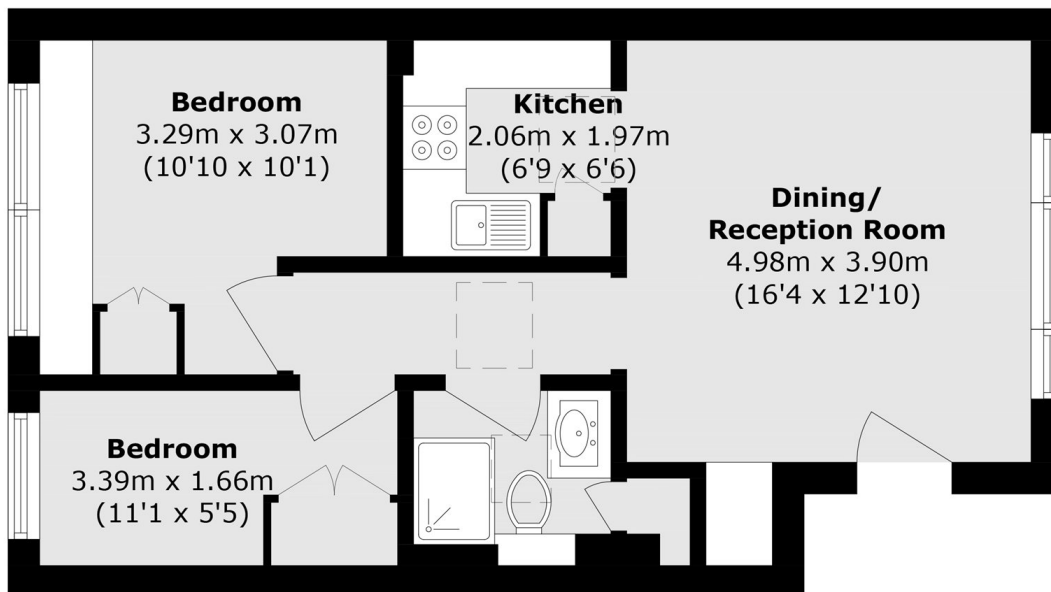

Total area (approx.): 44.4 sq. m (477.9 sq. ft)