



## 23 Titheway, Middle Littleton

Guide Price **£325,000**

## 23 Titheway

Middle Littleton, Evesham

Council Tax band: C

Tenure: Freehold

EPC Energy Efficiency Rating: C

EPC Environmental Impact Rating: C

- Spacious three-bedroom family home
- Attractive village location
- Open-plan kitchen, dining and family room
- Separate lounge with feature fireplace
- Useful pantry/storage area
- Excellent access to Evesham, Broadway and Stratford-upon-Avon
- Ideal family home in a sought-after village setting
- Off road parking





## Ground Floor

Approx. 56.7 sq. metres (610.7 sq. feet)

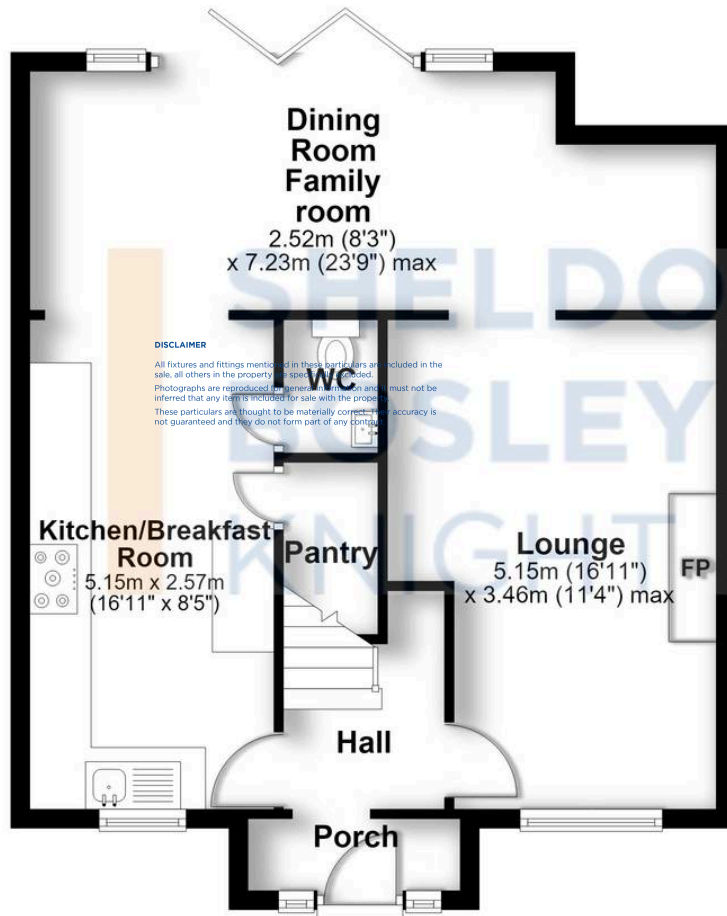

### DISCLAIMER

All fixtures and fittings mentioned in these particulars are included in the sale, all others in the property are specifically excluded. Photographs are reproduced for general information and it must not be inferred that any item is included for sale with the property. These particulars are thought to be materially correct. Their accuracy is not guaranteed and they do not form part of any contract.

## First Floor

Approx. 39.3 sq. metres (423.1 sq. feet)

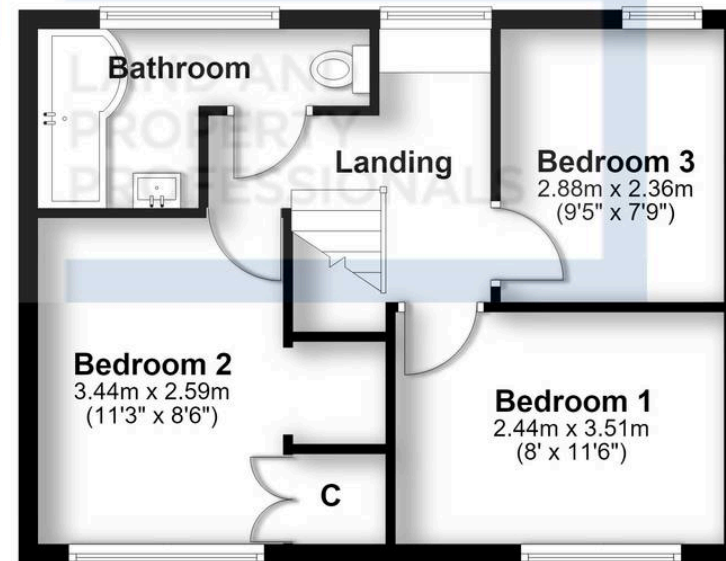

Total area: approx. 96.0 sq. metres (1033.8 sq. feet)

All efforts have been made to ensure the measurements are accurate on this floor plan, however these are for guidance purposes only.  
Plan produced using PlanUp.

# Sheldon Bosley Knight Evesham & Pershore

Sheldon Bosley Knight, 1 Bridge Street, Evesham - WR11 4SQ

01386444900 · eveshamsales@sheldonbosleyknight.co.uk · www.sheldonbosleyknight.co.uk/

### DISCLAIMER

All fixtures and fittings mentioned in these particulars are included in the sale, all others in the property are specifically excluded.

Photographs are reproduced for general information and it must not be inferred that any item is included for sale with the property.

These particulars are thought to be materially correct. Their accuracy is not guaranteed and they do not form part of any contract.