



End Terraced Villa

9 Wentworth Square, Kilwinning, KA13 6RQ



taylorandhenderson.co.uk

3		4		2		E	EPC rating
---	--	---	--	---	--	---	----------------------



9 Wentworth Square

Taylor & Henderson are delighted to bring to the market this rarely available detached villa located within a popular residential area. The accommodation comprises entrance vestibule, w/c, seating/dining area with storage cupboard, master bedroom, open planned lounge, dining kitchen with patio and side to the rear garden all on the ground floor. The upper level comprises 3 double bedrooms and a bathroom. The property further benefits from generous storage space, gas central heating and double glazing. The front garden has a monoblocked driveway in front of the attached garage and a decorative chipped area to the left. The enclosed rear garden has a paved patio seating area and a timber garden shed. Kilwinning offers an array of local amenities to include primary and secondary schools, bus routes, local shops. It is also within easy access of road and rail links to Glasgow in the north, all west coast towns train including Ayr to the south and thus is well located for travel throughout west central Scotland.

Measurements

Entrance porch	6'0 x 3'1
WC	6'0 x 2'1
Dining Room	12'0 x 11'0
Lounge	11'0 x 14'0
Dining Kitchen	22'0 x 11'0
Master Bedroom	14'0 x 7'0
Bedroom 2	12'0 x 8'1
Bedroom 3	11'0 x 8'0
Bedroom 4	10'0 x 9'1
Bathroom	6'0 x 6'1

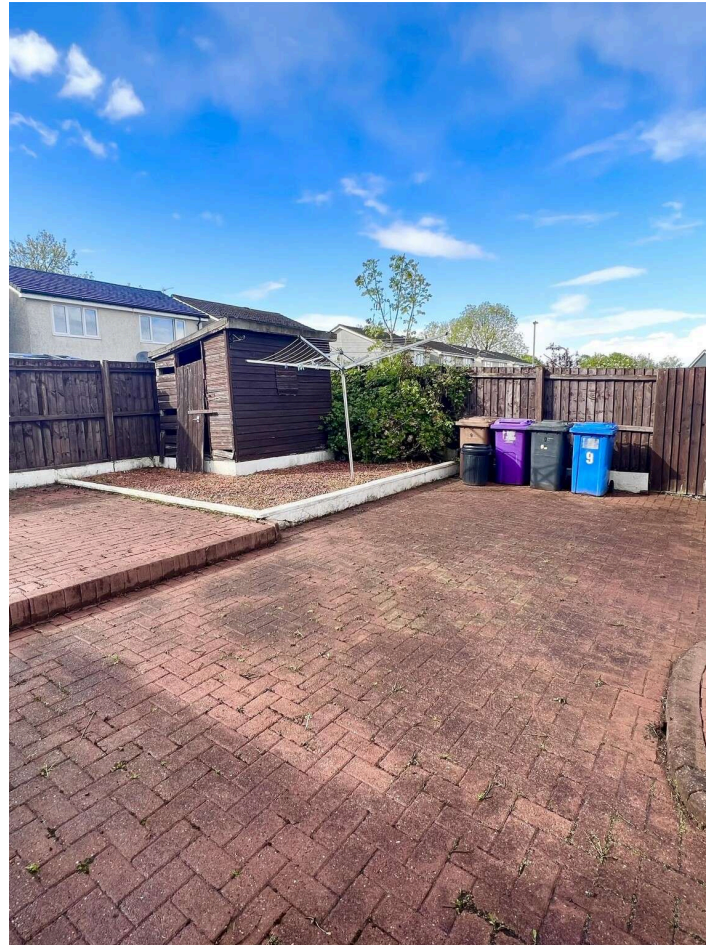

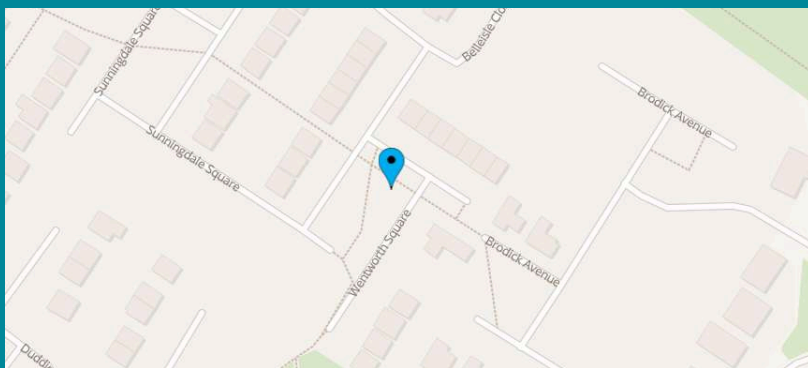

Viewing
Through solicitors on 01294 606700

Email
property@taylorandhenderson.co.uk

Reference
E504801

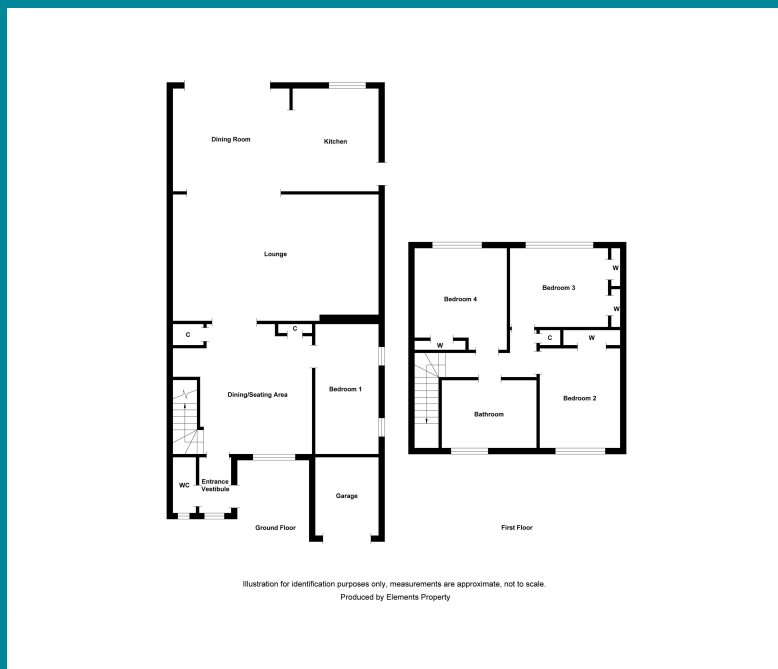

Illustration for identification purposes only, measurements are approximate, not to scale
Produced by Elements Property

Our Offices

51 Hamilton Street, Saltcoats, Ayrshire, KA21 5DX
Tel: 01294 606700 & Fax: 01294 464827

22 Bank Street, Irvine, Ayrshire, KA12 0AG
Tel: 01294 278306 & Fax: 01294 272886

83 Main Street, Kilwinning, Ayrshire, KA13 6AN
Tel: 01294 557506 & Fax: 01294 558552
Email: property@taylorandhenderson.co.uk

espc rightmove  ZOOPLA  OnTheMarket



DISCLAIMER: Whilst we endeavour to make these particulars as accurate as possible, they do not form part of any contract of offer, nor are they guaranteed. Measurements are approximate and in most cases are taken with a digital/sonic-measuring device and are taken to the widest point. We have not tested the electricity, gas or water services or any appliances. Photographs are reproduced for general information and it must not be inferred that any item is included for sale with the property. If there is any part of this that you find misleading or simply wish clarification on any point, please contact our office immediately when we will endeavour to assist you in any way possible.