



Townmead Road, SW6

£507 Per week

This spacious studio offers a modern fully fitted open plan kitchen living room with wood floors throughout, a modern tiled bathroom and 24 hour concierge with water rates included. Available in September

Imperial Wharf offers a number of excellent restaurants and the river bus service provides access to Blackfriars and Putney Piers.

Features

- Modern Studio
- Integrated Kitchen
- Gym Access
- Water Included
- 24hrs Concierge
- Imperial Wharf Station

Townmead Road, London, SW6

Fourth Floor

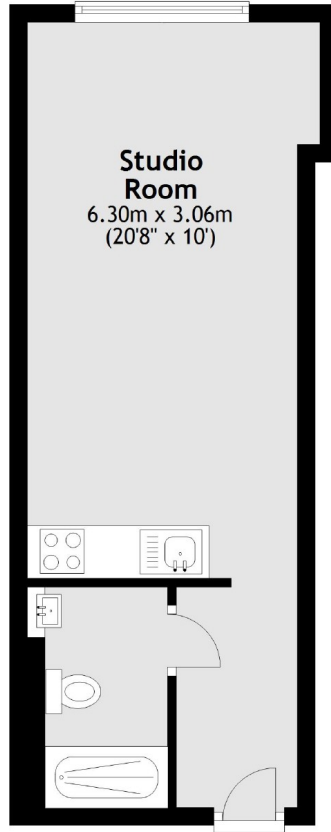

Total area: approx. 27.6 sq. metres (296.9 sq. feet)