



Connells

Riverbanks Close
Harpenden



Property Description

A beautifully presented three-bedroom end of terrace family home situated within a Cul de sac location of only twelve dwellings overlooking the River Lea being offered chain free. The property offers well balanced accommodation throughout to include a 15ft lounge overlooking a south facing rear garden, garage and ample parking. Within 0.9 miles of the mainline station and close proximity of excellent primary and secondary schools.

On the first floor there are two double bedrooms, a generous single bedroom and family bathroom. To the rear the good size garden leads onto the River Lea, mostly laid to lawn with a paved patio area for entertaining. The property also has further potential to extend subject to the usual planning consents.



Key Features:

- A modern three-bedroom end of terrace family home
- 15ft lounge
- Generous size South facing garden
- Driveway for two to three cars
- Single garage
- River views
- Potential to extend STPP
- Downstairs cloakroom







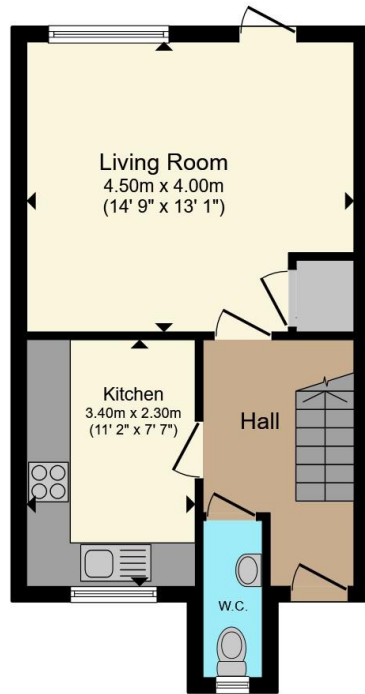

Ground Floor

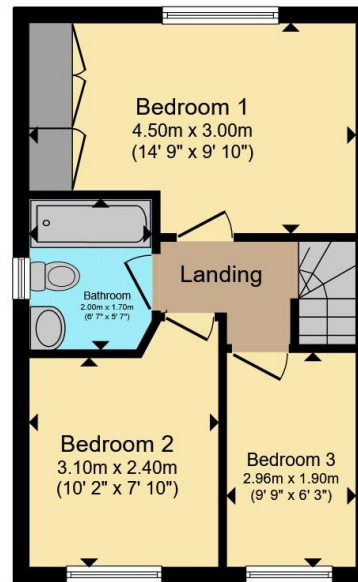

First Floor

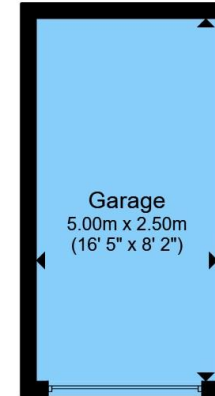

Garage

Total floor area 81.0 m² (872 sq.ft.) approx

This floor plan is for illustrative purposes only. It is not drawn to scale. Any measurements, floor areas (including any total floor area), openings and orientation are approximate. No details are guaranteed, they cannot be relied upon for any purpose and they do not form part of any agreement. No liability is taken for any error, omission or misstatement. A party must rely upon its own inspection(s). Powered by www.propertybox.io



To view this property please contact Connells on

T 01582 760 131
E harpenden@connells.co.uk

50 High Street
HARPENDEN AL5 2SU

EPC Rating: C Council Tax
Band: E

Tenure: Freehold

view this property online connells.co.uk/Property/HPN307031



1. MONEY LAUNDERING REGULATIONS Intending purchasers will be asked to produce identification documentation at a later stage and we would ask for your co-operation in order that there will be no delay in agreeing the sale. 2. These particulars do not constitute part or all of an offer or contract. 3. The measurements indicated are supplied for guidance only and as such must be considered incorrect. Potential buyers are advised to recheck measurements before committing to any expense. 4. We have not tested any apparatus, equipment, fixtures, fittings or services and it is in the buyers interest to check the working condition of any appliances.

Connells Residential is registered in England and Wales under company number 1489613, Registered Office is Cumbria House, 16-20 Hockliffe Street, Leighton Buzzard, Bedfordshire, LU7 1GN. VAT Registration Number is 500 2481 05.

See all our properties at www.connells.co.uk | www.rightmove.co.uk | www.zoopla.co.uk

Property Ref: HPN307031 - 0012