



**25 PRINCESS HOUSE 144 PRINCESS STREET**  
**M1 7EP**

**£1,400 PCM**

A stunning apartment located in the popular Education Quarter with easy access to all the main University buildings. A spacious living room that leads to a large balcony, modern fully fitted kitchen, two large double bedrooms with ample wardrobe space. Two modern bathrooms and fully furnished to a high standard Available 9th July 2026.

**buckleyfrayne**

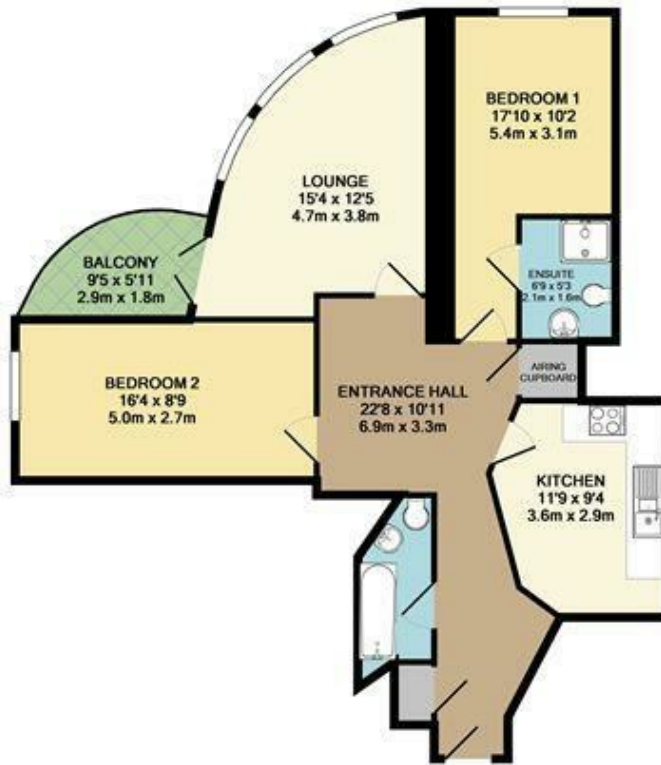

TOTAL APPROX. FLOOR AREA 778 SQ.FT. (72.2 SQ.M.)

Whilst every attempt has been made to ensure the accuracy of the floor plan contained here, measurements of doors, windows, rooms and any other items are approximate and no responsibility is taken for any error, omission, or mis-statement. This plan is for illustrative purposes only and should be used as such by any prospective purchaser. The services, systems and appliances shown have not been tested and no guarantee as to their operability or efficiency can be given.  
Made with Metropix ©2013



Energy Efficiency Rating		
	Current	Potential
Very energy efficient - lower running costs		
(92 plus) <b>A</b>		
(81-91) <b>B</b>		
(69-80) <b>C</b>	69	71
(55-68) <b>D</b>		
(39-54) <b>E</b>		
(21-38) <b>F</b>		
(1-20) <b>G</b>		
Not energy efficient - higher running costs		
<b>England &amp; Wales</b>	EU Directive 2002/91/EC	

Agents Note: Whilst every care has been taken to prepare these particulars, they are for guidance purposes only. All measurements are approximate and are for general guidance purposes only and whilst every care has been taken to ensure their accuracy, they should not be relied upon and potential buyers/tenants are advised to recheck the measurements

Manchester Office Lettings  
6-14 Great Ancoats Street  
Northern Quarter  
Manchester  
M4 5AZ

0161 236 0004  
mark.buckley@buckleyfrayne.co.uk  
www.buckleyfrayne.co.uk

**buckleyfrayne**