



8 New Street, South Hiendley, Barnsley, S72 9BT

Offered to the market with no onward chain is this three-bedroom terraced property is situated on New Street, South Hiendley.

The property represents an excellent opportunity for first-time buyers and investors alike.

The property boasts a spacious lounge and a separate dining room, providing generous and flexible living accommodation. The kitchen leads out to the rear, giving easy access to the enclosed yard, which also benefits from a useful storage building. Upstairs there are three excellent-sized bedrooms along with a bathroom situated off the main bedroom.

Furthermore the property features a cellar, ideal for additional storage and an outbuilding at the bottom of the garden.

Conveniently located close to local amenities and transport links, this property offers fantastic potential and is not to be missed.

£115,000

- Three bedroom terraced property
- Offered with no Onward Chain
- Ideal for First-Time Buyers or Investors
- Well Proportioned Living Space
- Close to local amenities and schools
- Cellar
- Outbuilding
- Close to County Walks
- Must See

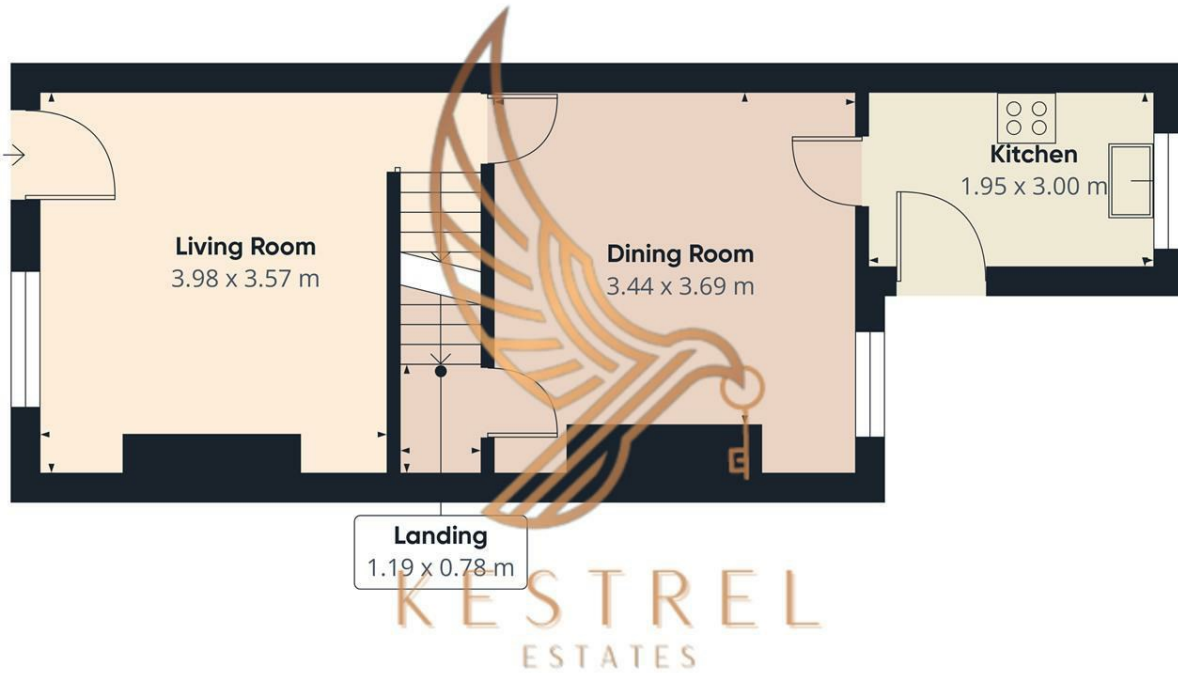

Approximate total area⁽¹⁾
35 m²

(1) Excluding balconies and terraces

Calculations reference the RICS IPMS 3C standard. Measurements are approximate and not to scale. This floor plan is intended for illustration only.

GIRAFFE360

Energy Efficiency Rating		Current	Potential
<i>Very energy efficient - lower running costs</i>			
(92 plus) A			
(81-91) B			
(69-80) C			
(55-68) D			
(39-54) E			
(21-38) F			
(1-20) G			
<i>Not energy efficient - higher running costs</i>			
England & Wales		EU Directive 2002/91/EC	