

Dorset Way, TW2

£750,000

A three bedroom mid terrace house offered in this sought after location benefitting from off street parking, a garage and potential to extend STPP. This property is not to be missed.

Dorset Way is ideally located within a mile of some of the area's most sought-after primary and secondary schools, including Waldegrave and Trafalgar. The property is also just a stone's throw from popular green spaces with Kneller Gardens only 0.1 miles away. Whitton train station is conveniently within walking distance, approximately 0.5 miles from the property.

Features

- No Onward Chain
- Three Bedrooms
- Off Street Parking
- Garage
- Fantastic Location
- Potential To Extend STPP

Dorset Way, Twickenham, TW2

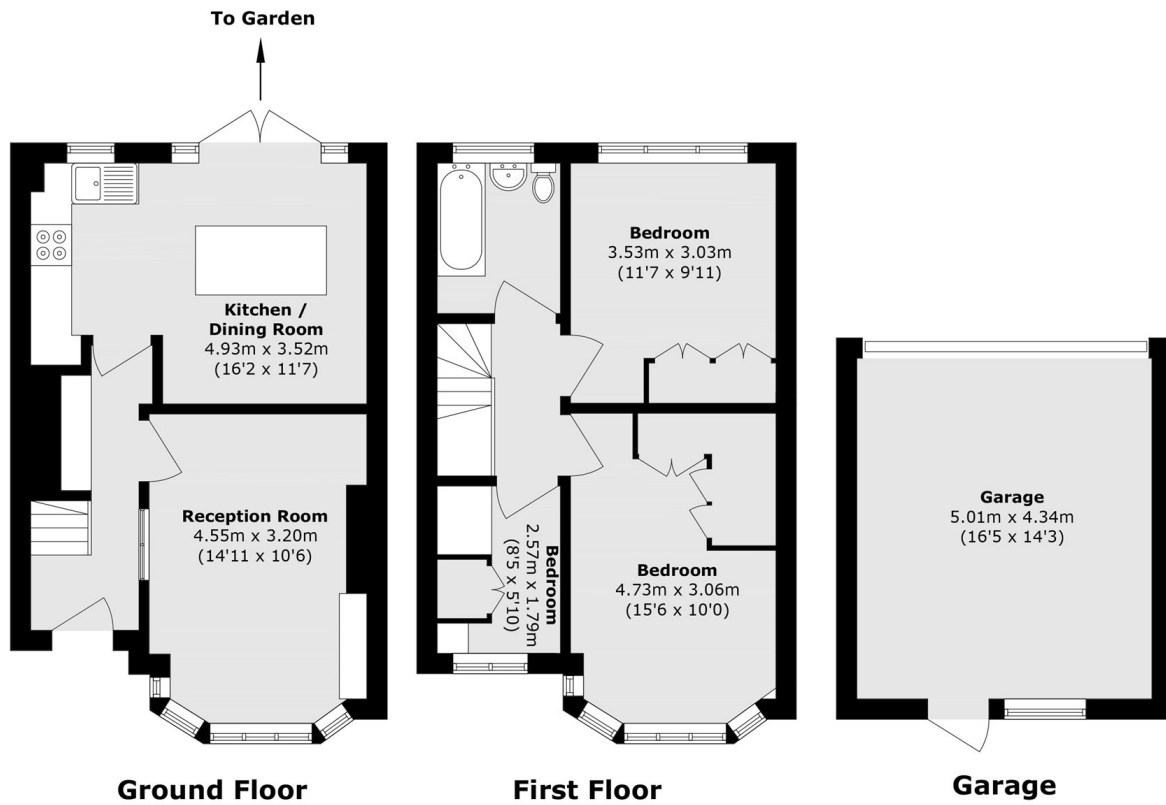

Total area (approx.): 76.2 sq. m (820.2 sq. ft)
Garage area (approx.): 21.7 sq. m (233.5 sq. ft)