

£1,750 Per Month

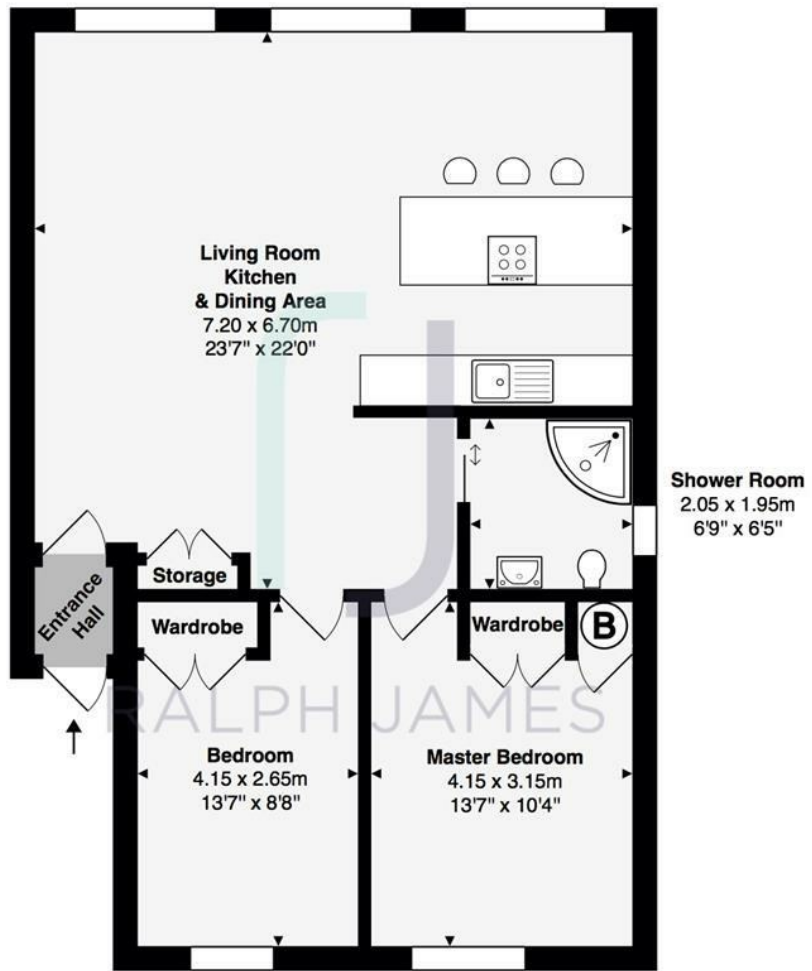



Hooley Lane, Redhill

Total Area: 74.0 m² ... 796 ft² (Excluding Entrance Hall)

All measurements are approximate and for display purposes only



This modern two Bedroom, luxury apartment is in a great location just opposite a green and only a short walk to Redhill Town Centre, Earlswood Station and Redhill Station.

The apartment has been finished to a high standard throughout and offers a spacious living area with an open plan high end fully fitted kitchen. The living area has three floor to ceiling windows which exudes the natural daylight into the room and has an outlook over the local common.

The Kitchen includes integrated appliances including fridge freezer, washing machine, full size dishwasher, oven, hob and extractor. Stunning white Corian work surfaces including a breakfast bar with seating area and lighting above.

Both the master bedroom and second bedroom have built in wardrobes, contemporary crystal lighting and full height windows giving them both a lovely bright aspect. The modern luxury shower room has wall and floor tiling with a modern sink/vanity unit and a full width mirror. The shower has a large rainfall shower head.



Thomas likes it
because...

