



Beckway Street, London, SE17 1TW

Fibre Broadband Included in Rent

HMO APPROVED

A spacious three bedroom apartment located a walk away from Elephant and Castle station and surrounded by local amenities.

The apartment boasts a generous reception room with access to a private balcony, a separate kitchen with space to dine, three double bedrooms, and a well-kept family bathroom. Additional storage can be found in the hallway.

The apartment is surrounded by many local amenities such as supermarkets, restaurants, cafes. Burgess Park, and good bus routes into central London.

- Spacious Three Bedroom Apartment
- Private Balcony
- Separate Kitchen
- Excellent Location
- Furnished
- Fibre Broadband Included in Rent
- Good Transport Links

£2,750 Per month

Alex & Matteo
ESTATE AGENTS

Offham House SE17

Approximate Area = 736 sq ft / 68.4 sq m

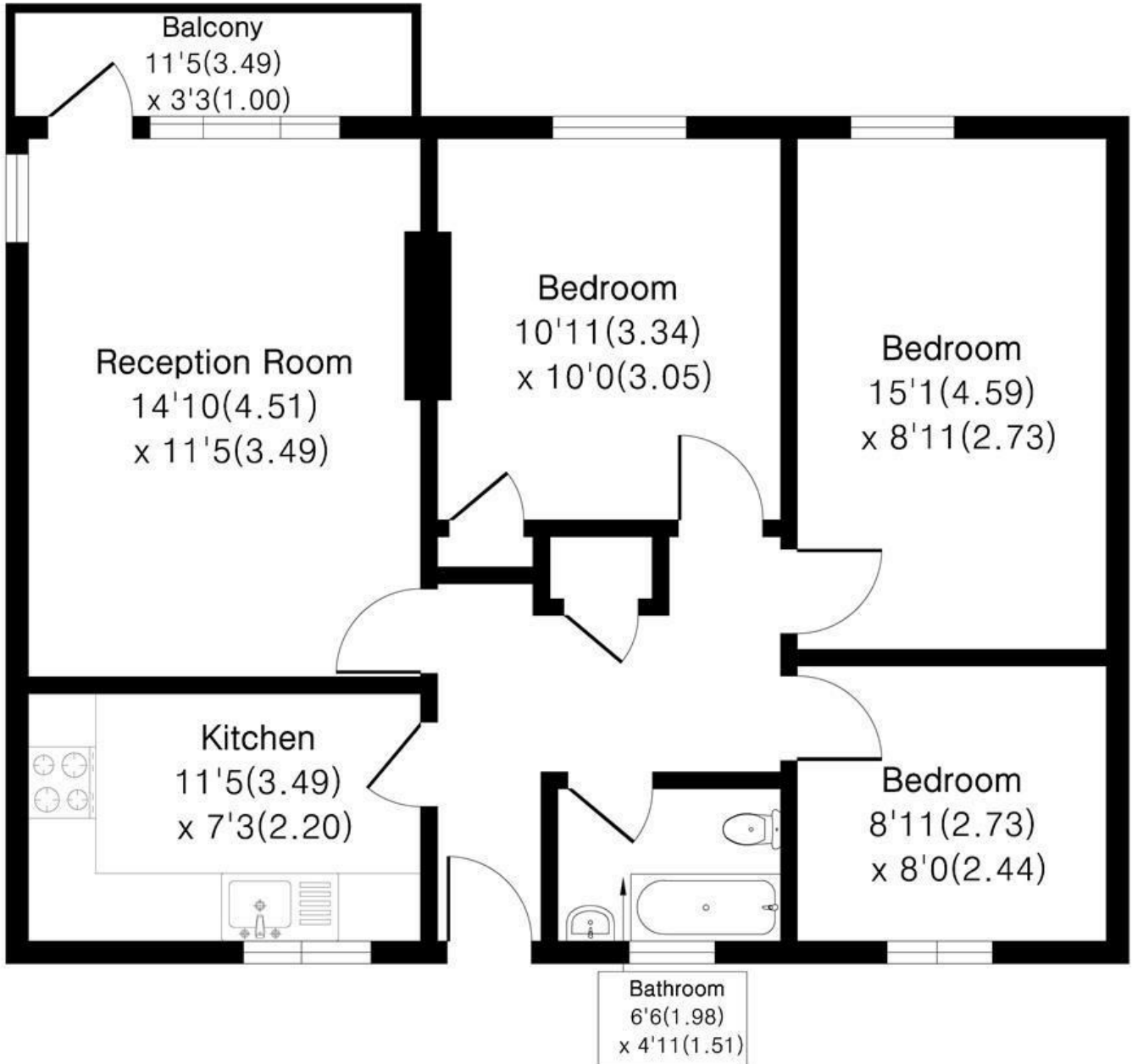

Floor plan Produced in accordance with RICS Property Measurement 2nd Edition. Incorporating International Property Measurement Standards (IPMS2 Residential). Produced for Alex & Matteo Estate Agents.

| Energy Efficiency Rating | | Current | Potential |
|---|--|-------------------------|-----------|
| Very energy efficient - lower running costs | | | |
| (92 plus) A | | | |
| (81-91) B | | | |
| (69-80) C | | 79 | 79 |
| (55-68) D | | | |
| (39-54) E | | | |
| (21-38) F | | | |
| (1-20) G | | | |
| Not energy efficient - higher running costs | | | |
| England & Wales | | EU Directive 2002/91/EC | |