



Cromwell Road, SW5

£500,000



- Beautiful condition
- One double bedroom
- Third floor

Cromwell Road, SW5

APPROX. GROSS INTERNAL FLOOR AREA 488 SQFT / 45.34 SQM

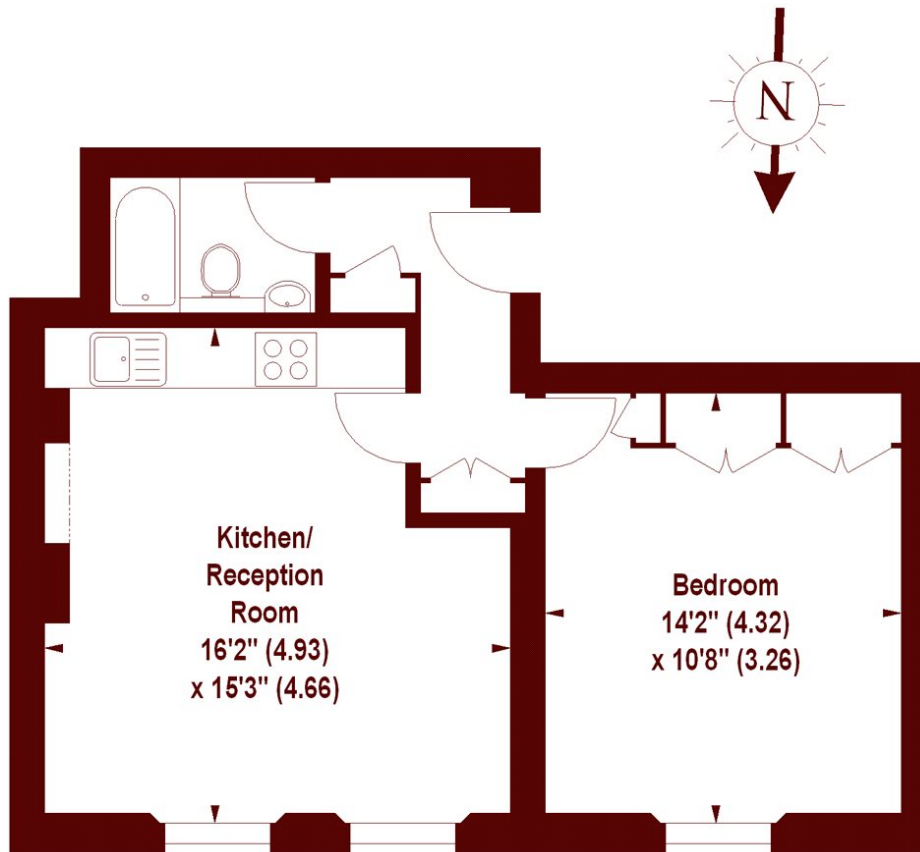

THIRD FLOOR

Illustration For Identification Purposes Only. Not To Scale

*Floorplan Drawn According To RICS Guidelines

Copyright of FeaturePRO

Marsh & Parsons South Kensington

29 Harrington Road, London,
SW7 3HD
020 7590 0800