



## Creffield Road, W3

£335,000

A modern one bedroom apartment with a private balcony that has stunning views over Twyford Avenue Sports Ground. This top floor flat comes with allocated off street parking, large attic space for storage and has a share of the freehold.

Creffield Road is within half a mile of both West Acton and Ealing Common and under a mile from Acton Mainline (Elizabeth line) stations, all of which offer excellent access into town.

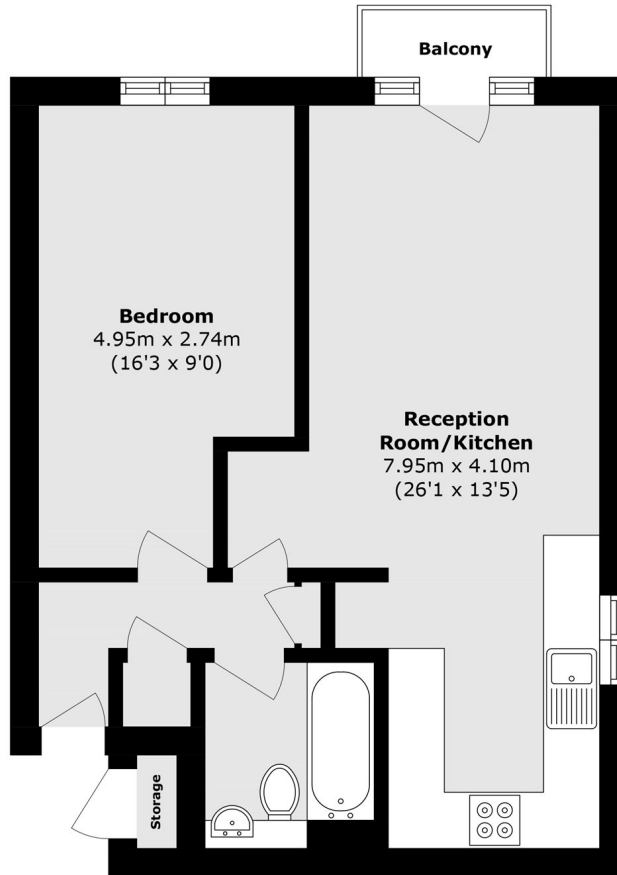

Total area (approx.): 45.3 sq. m (487.6 sq. ft)  
Balcony area (approx.): 1.4 sq. m (15.0 sq. ft)  
External Storage (approx.): 0.6 sq. m (6.4 sq. ft)

Robertson Smith & Kempson Acton Sales  
137 High Street, Acton,  
London, W3 6LY  
020 8896 3996  
[actonsales@robertsonsmithandkempson.co.uk](mailto:actonsales@robertsonsmithandkempson.co.uk)

Energy Rating: C. We aim to make our particulars both accurate and reliable. However they are not guaranteed; nor do they form part of an offer or contract. If you require clarification on any points then please contact us, especially if you're traveling some distance to view. Please note that appliances and heating systems have not been tested and therefore no warranties can be given as to their good working order.