

ASKING PRICE

**£1,350,000**

**Lancaster Close**

, BR2 0QF



EPC RATING: C COUNCIL TAX BAND: G

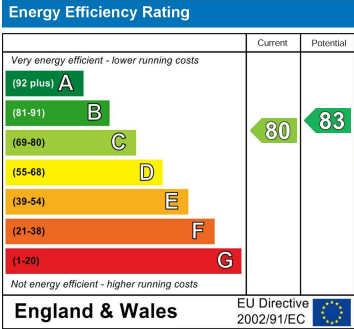
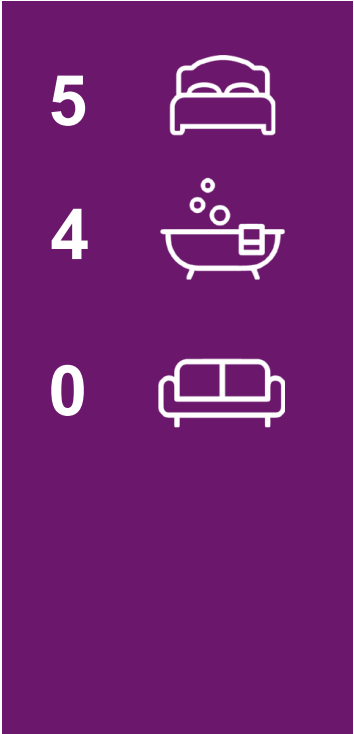
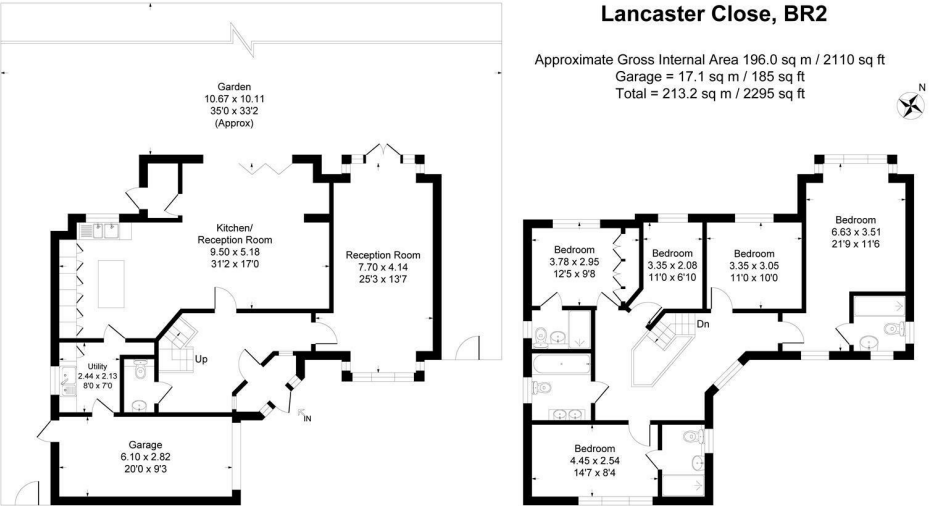

Agents Note: Whilst every care has been taken to prepare these particulars, they are for guidance purposes only. All measurements are approximate and are for general guidance purposes only and whilst every care has been taken to ensure their accuracy, they should not be relied upon and potential buyers/tenants are advised to recheck the measurements

**Sinclair Hammelton**

**OFFICE ADDRESS**  
23 High Street  
Bromley  
Kent  
BR1 1LG

**OFFICE DETAILS**  
0208 464 5566  
info@sinclairhammelton.co.uk