

East Street, St. Ives, PE27 5PD

Offers Over £230,000

🛏 2 🚿 2 🚗 2



- Characterful two-bedroom end-of-terrace with no onward chain
- Bright sitting room flowing through to a generous dining room
- Stylish kitchen with shaker units and warm wood worktops
- Useful pantry and separate utility room with W.C.
- Two well-proportioned bedrooms on the first floor
- Low-maintenance courtyard garden, perfect for easy outdoor living
- Large storage shed keeping everything neat and organised
- Central St Ives location close to shops, coffee shops and Guided Bus.
- Virtual tour available by request
- EPC Rating D/59.

Ground Floor
Area: 45.2 m² ... 487 ft²

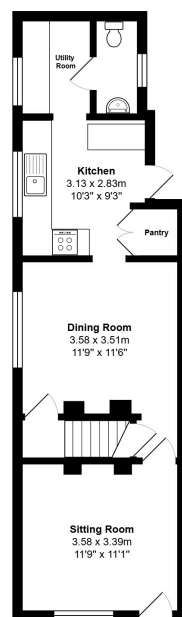

First Floor
Area: 38.7 m² ... 416 ft²

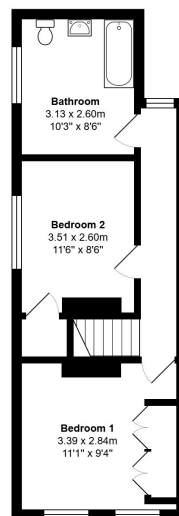

Total Area: 83.9 m² ... 903 ft²

All measurements are approximate and for display purposes only

Tucked away on East Street in the heart of St Ives, this two-bedroom end-of-terrace is packed with character. With no onward chain, and a layout that just works.