

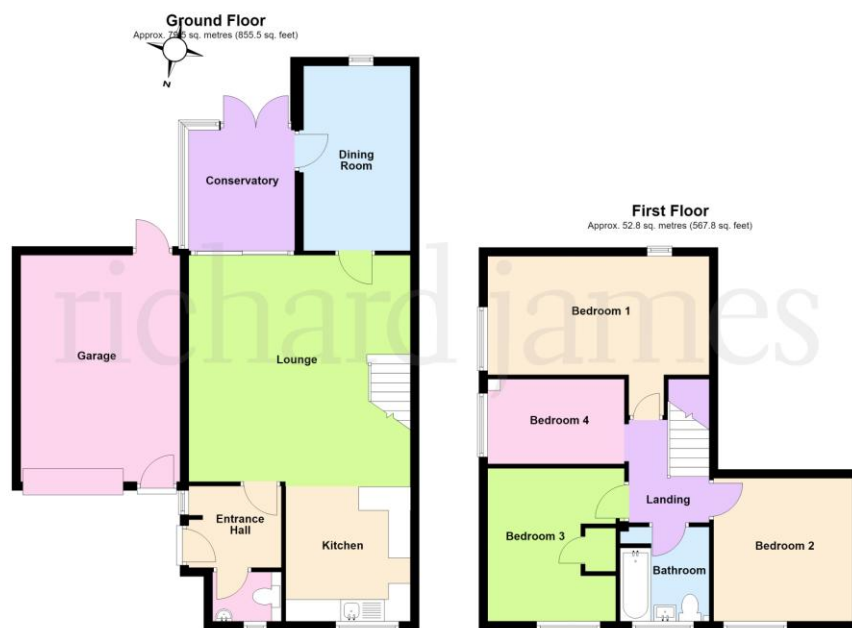

Torksey Close Corby NN18 9PL

**Monthly Rental Of £1,500 pcm**



This plan is a guide only to represent the layout of the property and is not totally to scale. The bathroom fittings and kitchen units may vary in shape and size.

**Lettings & Management**  
27 Sheep Street Wellingborough  
Northants NN8 1BS  
01933 424666

Available for immediate possession is this open plan four bedroom property that has been extended to the ground floor to provide a dining room/fifth bedroom. The property benefits from uPVC double glazed doors and windows, gas radiator central heating, a refitted kitchen and bathroom, the addition of a conservatory and solar panels will be fitted by the landlord shortly to minimise energy bills and improve EPC rating. The accommodation briefly comprises entrance hall, cloakroom, open plan lounge/kitchen, dining room, conservatory, four bedrooms, bathroom, gardens to front and rear and a garage.

Enter via entrance door.

#### **Entrance Hall**

#### **Cloakroom**

#### **Lounge**

16' 11" x 16' 08" (5.16m x 5.08m)

#### **Dining Room**

13' 11" x 7' 8" (4.24m x 2.34m)

#### **Kitchen**

10' 9" x 9' 5" (3.28m x 2.87m) (This measurement includes area occupied by the kitchen units)

#### **Conservatory**

11' 0" x 7' 11" (3.35m x 2.41m)

#### **First Floor Landing**

#### **Bedroom One**

16' 8" x 8' 9" plus door recess (5.08m x 2.67m)

#### **Bedroom Two**

10' 8" x 10' 4" (3.25m x 3.15m)

#### **Bedroom Three**

11' 9" max x 10' 4" narrowing to 7' 3" (3.58m x 3.15m)

#### **Bedroom Four**

10' 4" x 6' 4" (3.15m x 1.93m)

#### **Bathroom**

#### **Outside**

Gardens to front and rear.

Off road parking

Garage.

#### **Council Tax**

We understand the council tax is band B (£1,858 per annum. Charges for 2026/2027).

#### **Energy Performance Certificate**

This property has an energy rating of D. The full Energy Performance Certificate is available upon request.

#### **General Data Protection Regulations 2018**

Should you wish to view this property, we will require certain pieces of personal information in order to provide a professional service to you and our client.

The personal information provided by you may be shared with the landlord, but it will not be shared with any other third parties without your consent.

If you wish to apply for a tenancy, you must complete the tenancy application form. The personal information supplied in the application form will be passed to our management department and our referencing company who carry out credit and referencing checks and provide us with a report on your suitability as a tenant.

In completing the application, you agree that the application can be passed to them for this purpose.

More information on how we hold and process your data is available on our website - [www.richardjames.net](http://www.richardjames.net)

#### **Tenant Requirements**

- First month's rent of £1,500 pcm
- Deposit of £1,730
- Your details will be submitted to our referencing company, who will carry out a credit check and obtain previous landlord references and employment references
- Proof of identification (passport or driving licence and proof of address i.e. utility bill)
- Right to remain documents (if applicable)
- Holding deposit of £346.15 (one weeks' rent). This is to reserve a property, subject to referencing. Please note: This will be retained if any relevant person (including any guarantor(s)) withdraw from the tenancy, fail a Right-to-Rent check, provide materially significant false or misleading information, or fail to sign their tenancy agreement (and/or Deed of Guarantee) within 15 calendar days (or other Deadline for Agreement as mutually agreed in writing). This holding deposit will be returned within 15 days or apportioned to rent with the prospective tenants consent if referencing is successful.

£3,230 (Total)

Client deposits are protected by the Tenancy Deposit Scheme. Please note we are unable to accept debit or credit card payments.

#### **Home contents insurance**

We require our tenants to have home contents insurance. This not only covers the tenants belongings, but also covers their liability to the landlord for damage to his property. Please ask for further information.