

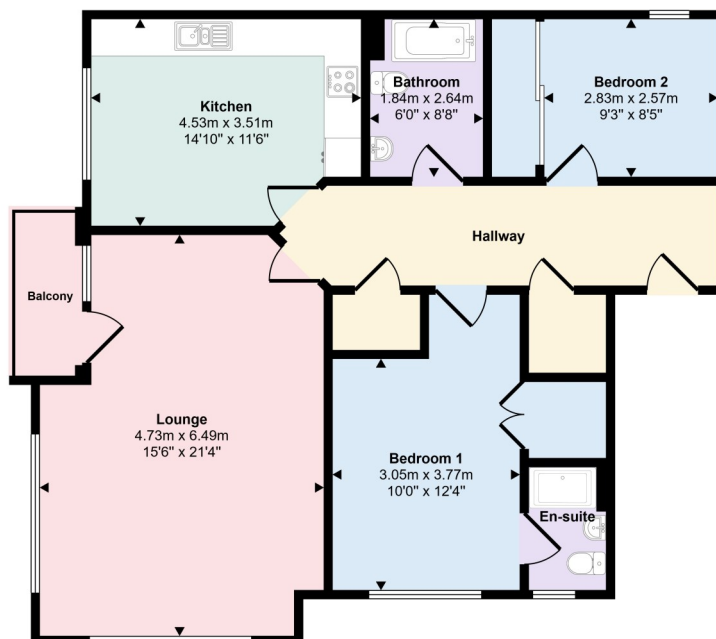

3/1, 2 Denny Crescent, Dumbarton, G82 1JL

Beautifully presented and filled with natural light, this stylish two-bedroom top-floor apartment offers an exceptional standard of modern living within the sought-after Castle Quay development. Originally the Turnberry show flat, it enjoys upgraded finishes, generous room sizes and impressive open views that create a wonderful sense of space.

Approx Gross Internal Area
93 sq m / 1006 sq ft



Floorplan

This floorplan is only for illustrative purposes and is not to scale. Measurements of rooms, doors, windows, and any items are approximate and no responsibility is taken for any error, omission or mis-statement. Icons of items such as bathroom suites are representations only and may not look like the real items. Made with Made Snappy 360.



David Muir Estate Agents
2 Church Street, Dumbarton,
G82 1QL



Tel 01389 734366
Fax 01389 742476



tracy@davidmuirestates.co.uk



davidmuirestates.com



davidmuirestates

Travel Directions

From Glasgow Road travelling East take the right turn into Leven Street. Veer left and then take first right into the Turnberry development. No 2 is on your right at the corner of Leven Street and Denny Crescent. The flat is located on the top floor. Door entry system in operation.

Additional Information

Home Report Valuation: £200,000
Asking Price: Fixed Price £195,000
Council Tax Band: E
Energy Efficiency Rating:
Gas Central Heating
Double Glazing

Home Report

This property benefits from a Home Report which can be obtained from davidmuirestates.com or onesurvey.org

Disclaimer

These property details are set out as a general outline only and do not constitute any part of an Offer or Contract. All fixtures and fittings mentioned in these particulars are included in the sale. All others in the property are specifically excluded. Photographs are reproduced for general information and it must not be inferred that any item is included for sale with the property. All measurements, distances and areas are approximate and for guidance only.