

4 Lynn Road, East Winch PE32 1NP

£229,995

 3  1  1

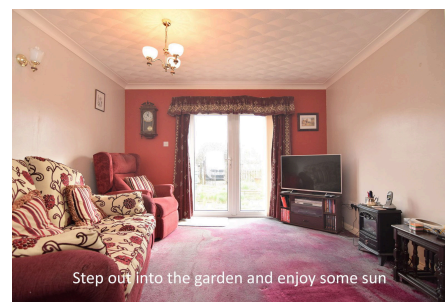

Far reaching, south facing views to the rear are one of the big selling points for this extended, 3 bedroom, detached bungalow which set in a non-estate location just 5 miles east of King's Lynn.

Key Features

- Detached bungalow
- Lounge / dining room
- Oil central heating
- Private parking
- Field views
- 3 Double bedrooms
- Extended
- South facing garden
- No chain
- Non-estate

GROUND FLOOR
883 sq. ft. (82.0 sq.m.) approx.

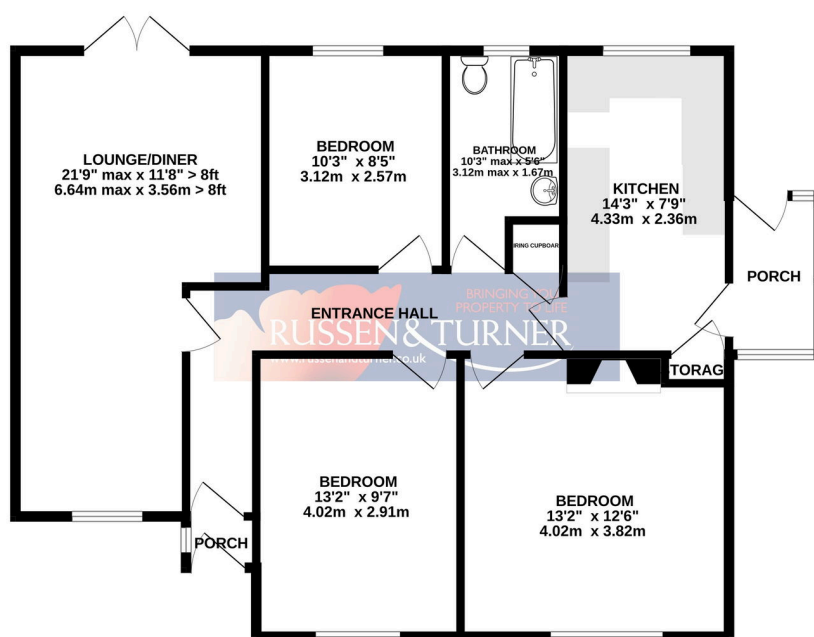

TOTAL FLOOR AREA: 883 sq. ft. (82.0 sq.m.) approx.

Whilst every attempt has been made to ensure the accuracy of the floorplan contained here, measurements of doors, windows, rooms and any other items are approximate and no responsibility is taken for any error, omission or mis-statement. This plan is for illustrative purposes only and should be used as such by any prospective purchaser. The services, systems and appliances shown have not been tested and no guarantee as to their operability or efficiency can be given.
Made with Metropix ©2024

