



King Edward's Road, E9

£350,000

One bedroom top floor apartment with city views, located in a small private block on King Edward's Road. The property features an open plan living and dining space with original steel windows, wooden flooring, and modern interior. There is a separate lockable storage unit on the ground floor that comes with the property and can accommodate two bicycles and other outdoor belongings.

King Edwards Road is moments from Broadway Market, Victoria Park and London Fields. London Fields Station, Bethnal Green Station and Hackney Central Station are all less than half a mile away.

Features

- Top Floor Flat
- Local Amenities
- Open Plan Living
- Original Steel Windows
- Lock Up Storage
- City Views

King Edward's Road, London, E9

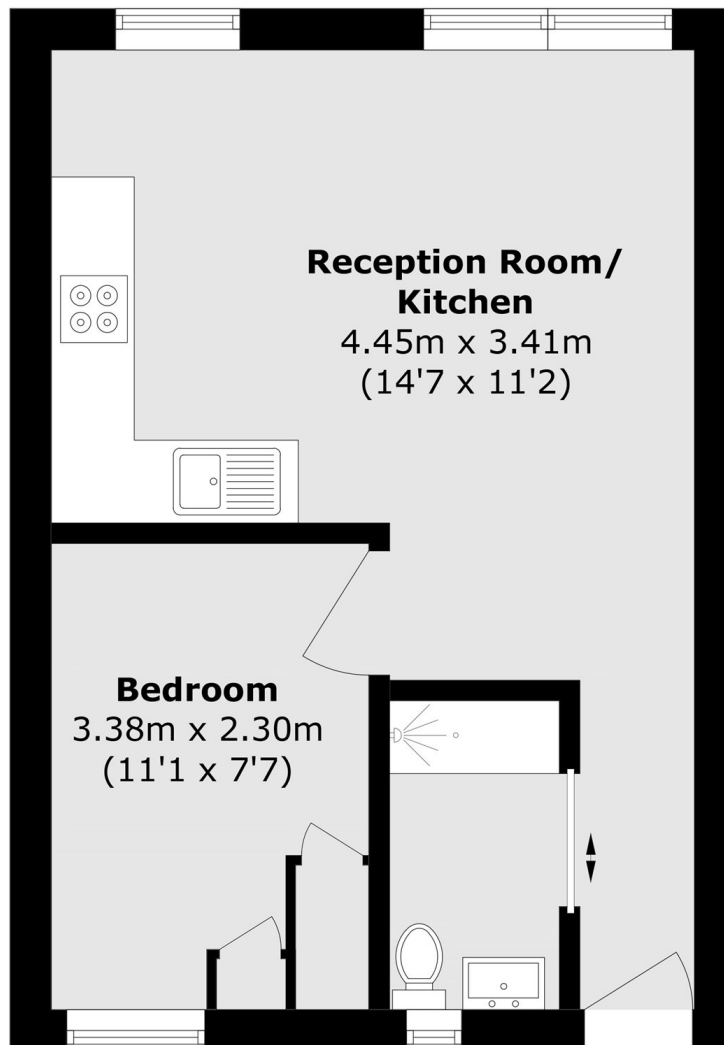

Total area (approx.): 30.9 sq. m (332.6 sq. ft)