



## Blackwall Way, E14

£2,000 Per calendar month

A large bright one bedroom apartment in this popular development which is located moments away from East India Station. The property has an open plan kitchen off the lounge. The bedroom is spacious and benefits from built-in wardrobes. The apartment has a private balcony, concierge and residents gym.

Elektron Tower is a modern development within walking distance of the shops, bars and restaurants of Canning Town and Canary Wharf.

### Features

- One Bedroom
- One Bathroom
- Concierge
- Balcony
- Modern
- Gym

Blackwall Way,  
London, E14

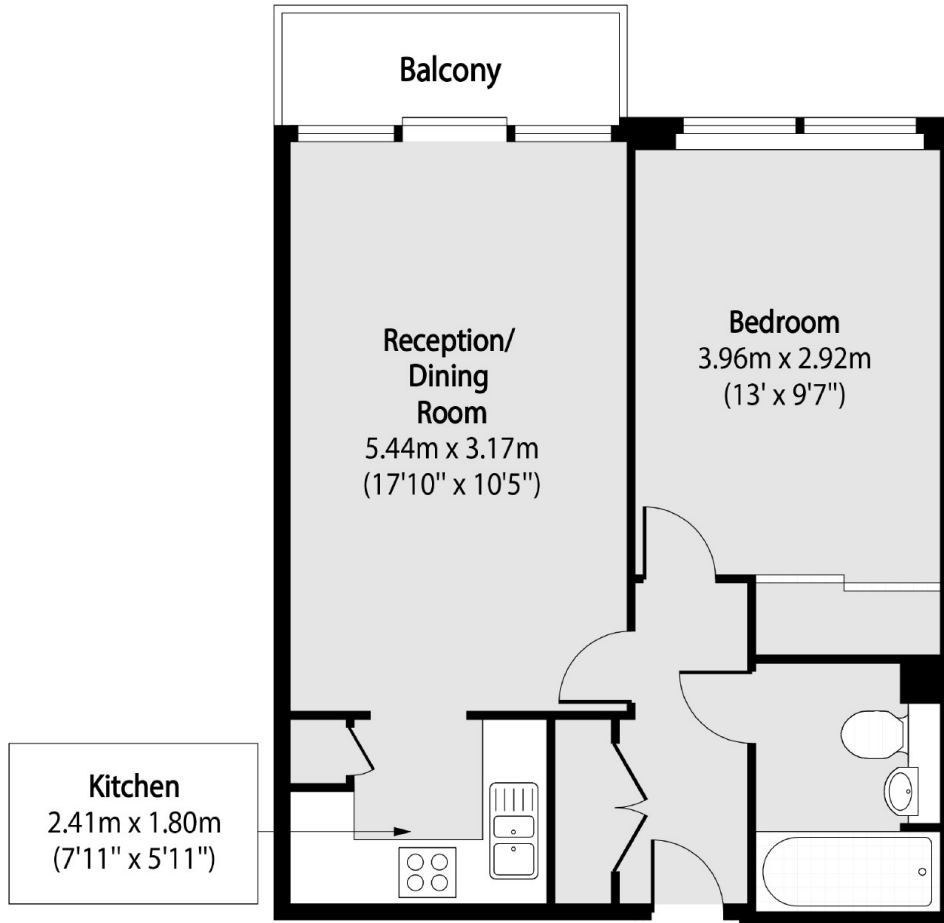

Total area (approx): 44.59 sq m (480 sq. ft)

Balcony total area (approx): 3.44 sq m (37 sq. ft)