

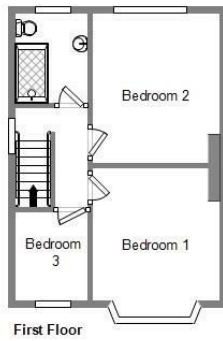

43 Olton Croft, Acocks Green, Birmingham, B27 6PG

£1,295 PCM



Bedroom 1 - 3.18m x 3.98m First Floor Front Right
 Bedroom 2 - 3.26m x 3.60m First Floor Rear Right
 Bedroom 3 - 1.60m x 2.65m First Floor Front Left
 Bathroom - 1.61m x 2.38m First Floor Rear Left
 Kitchen / Dining Room - 4.95m x 3.63m Ground Floor Rear
 Lounge - 3.22m x 3.82m Ground Floor Front Right

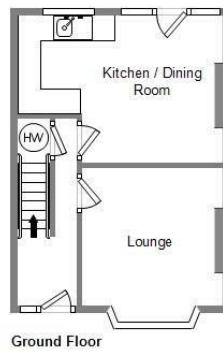

43 Olton Croft Acocks Green Birmingham B27 6PG

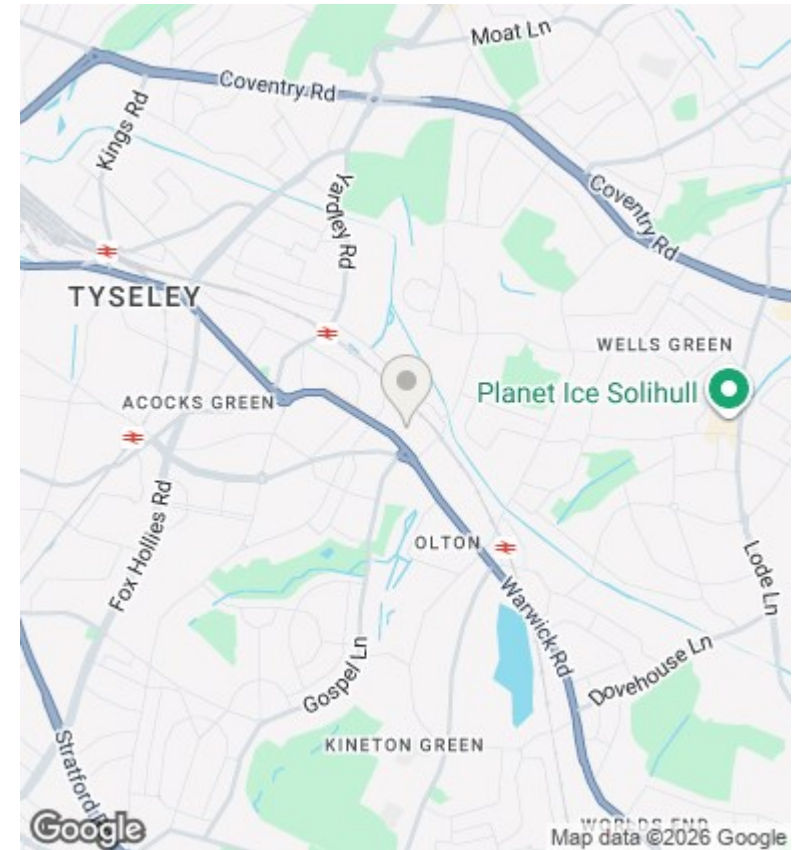

Directions

Viewings

Viewings by arrangement only.
 Call 01905 796 111 to make an appointment.

Council Tax Band

A

EPC Rating:

A

Energy Efficiency Rating		Current	Potential
Very energy efficient - lower running costs			
(92 plus) A		100	100
(81-91) B			
(69-80) C			
(55-68) D			
(39-54) E			
(21-38) F			
(1-20) G			
Not energy efficient - higher running costs			
England & Wales		EU Directive 2002/91/EC	