



CROMWELL CRESCENT, SW5

£325,000

Studio
One Bathroom
First Floor
Flexible Living Space
Share of Freehold
Central Location

@marshandparsons
marshandparsons.co.uk

MARSH &
PARSONS



ABOUT THE PROPERTY

A studio flat on the first floor, with a share of freehold in a prime Kensington location.

Cromwell Crescent is a desirable address running between Pembroke Road and down to West Cromwell Road within the Royal Borough of Kensington & Chelsea. Local amenities can be found close by on Kensington High Street and Earls Court Road. The address is conveniently located for access to High Street Kensington, Earls Court and Gloucester Road Underground Stations as well as the A4 main road providing access west out of London to Heathrow Airport and the west country.



STEP INSIDE CROMWELL CRESCENT

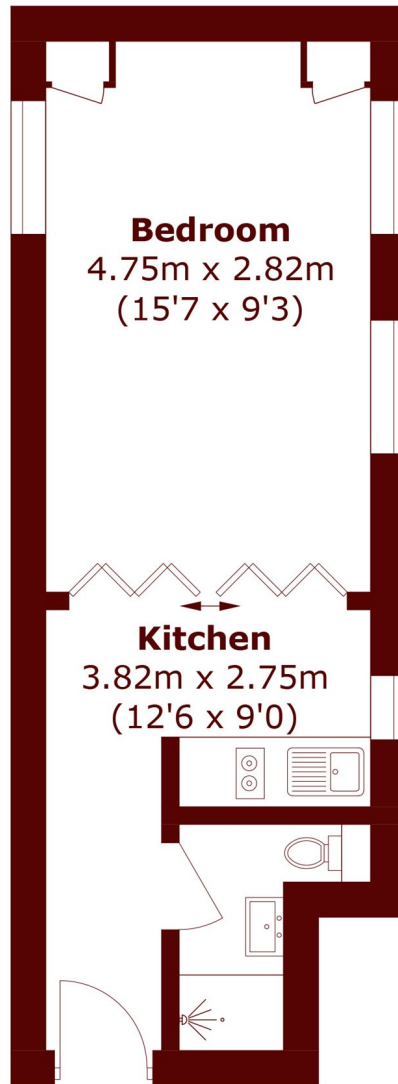

First Floor

Total area (approx.): 23.4 sq. m (251.9 sq. ft)

Kensington
020 7368 4450

Energy Rating: C We aim to make our particulars both accurate and reliable. However, they are not guaranteed; nor do they form part of an offer or contract. If you require clarification on any points then please contact us, especially if you're traveling some distance to view. Please note that appliances and heating systems have not been tested and therefore no warranties can be given as to their good working order

**MARSH &
PARSONS**