



Carlingford Road, Turnpike Lane, N15

£1,950 Per Month

2 1 1 D

## Floor Plan

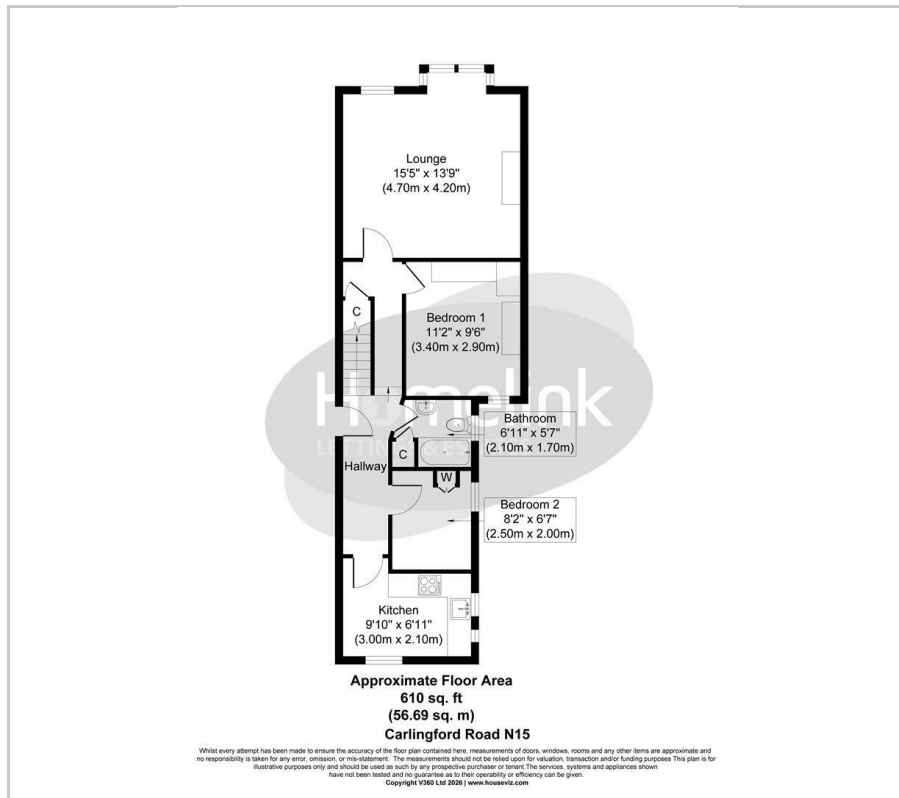

## Area Map



## Energy Efficiency Graph

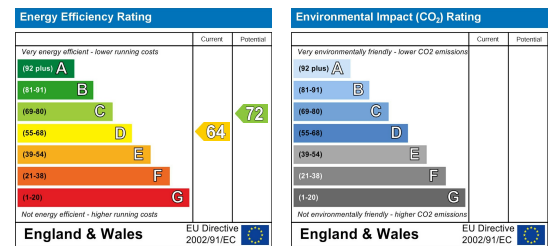

## Viewing

Please contact our Homelink Lettings & Estates Office on 0208 882 2112 if you wish to arrange a viewing appointment for this property or require further information.

- Two bedroom flat
- Stones throw away from Turnpike Lane underground station
- Furnished
- Gas central heating
- Close to local amenities
- First floor property
- Ideal for couples
- Available from the 1st August.
- Double glazed throughout
- Council tax band - C - Haringey

**\*\* IDEAL FOR COUPLES\*\*** Nestled on Carlingford Road in the vibrant area of Turnpike Lane, this charming two-bedroom flat presents an excellent opportunity for couples seeking a comfortable and convenient living space. The property boasts a well-proportioned reception room, perfect for relaxation and entertaining guests.

With two inviting bedrooms, this flat offers ample space for both rest and productivity, making it an ideal choice for those who appreciate a harmonious balance between work and leisure. The bathroom is thoughtfully designed, ensuring both functionality and comfort.

One of the standout features of this property is its prime location, just a stone's throw away from Turnpike Lane underground station. This provides easy access to central London and beyond, making commuting a breeze. The surrounding area is rich with local amenities, including shops, cafes, and parks, enhancing the overall appeal of this delightful flat.

Furnished and ready for you to move in, this property will be available from the 1st of August 2026. Whether you are a first-time renter or looking to downsize, this flat offers a perfect blend of style, convenience, and comfort. Do not miss the chance to make this lovely flat your new home.

Council tax band - C - Haringey  
Council tax amount - £2056.70



These particulars, whilst believed to be accurate are set out as a general outline only for guidance and do not constitute any part of an offer or contract. Intending purchasers should not rely on them as statements of representation of fact, but must satisfy themselves by inspection or otherwise as to their accuracy. No person in this firm's employment has the authority to make or give any representation or warranty in respect of the property.

Homelink Lettings and Estates  
62 Chase Side, London N14 5PA  
0208 882 2112 [homelink.co.uk](http://homelink.co.uk)

