



Croft Gardens, W7

£560,000

Newly converted garden maisonette which has been meticulously fitted by the current owner with much attention to detail.

Ideal for a purchaser looking for a property they can just move in to and unpack.

Private entrance to the reception hall which has a guest WC, main bedroom with a stylish ensuite shower room, second bedroom and a beautifully fitted kitchen/living room with bifold doors to the private rear garden.

Excellent location close to West Ealing and Hanwell stations for the Elizabeth line and the Piccadilly line at Northfields station.

Features

- New Conversion
- Two Bedrooms
- Stylish Finish
- Share of Freehold
- Landscaped Garden
- Residents Parking

Croft Gardens, London, W7

Ground Floor

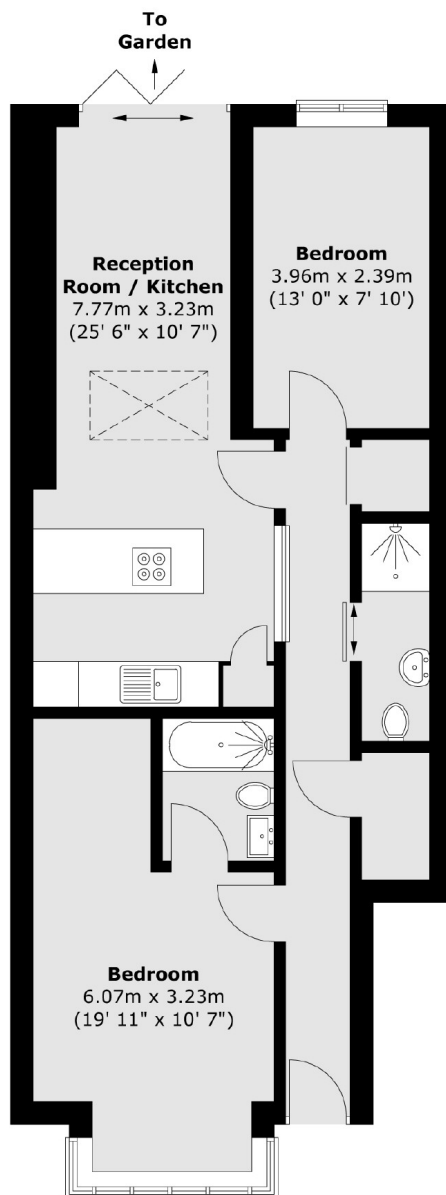

Total area (approx.) : 67.3 sq. m (724 sq. ft)