



Manor Road, TW2

£399,950

A charming top floor one bedroom period conversion apartment offered to the market with a private garden and non allocated off street parking. Presented beautifully this property is not to be missed out on.

Manor Road is within walking distance of Twickenham Green with a variety of shops, popular bars and restaurants and Kneller Gardens is a few minutes' walk away with pleasant walks along the River Crane to the nature conservation area. Commuter links are excellent with two stations nearby, providing frequent, direct services to London Waterloo and easy access to the M3/M25 motorways and Heathrow Airport. The surrounding area has numerous recreational facilities and central Twickenham is just 1 mile away.

Features

- One Bedroom
- Private Garden
- Period Conversion
- Top Floor
- Fantastic Location
- Non Allocated Off Street Parking

Manor Road, Twickenham, TW2

Second Floor

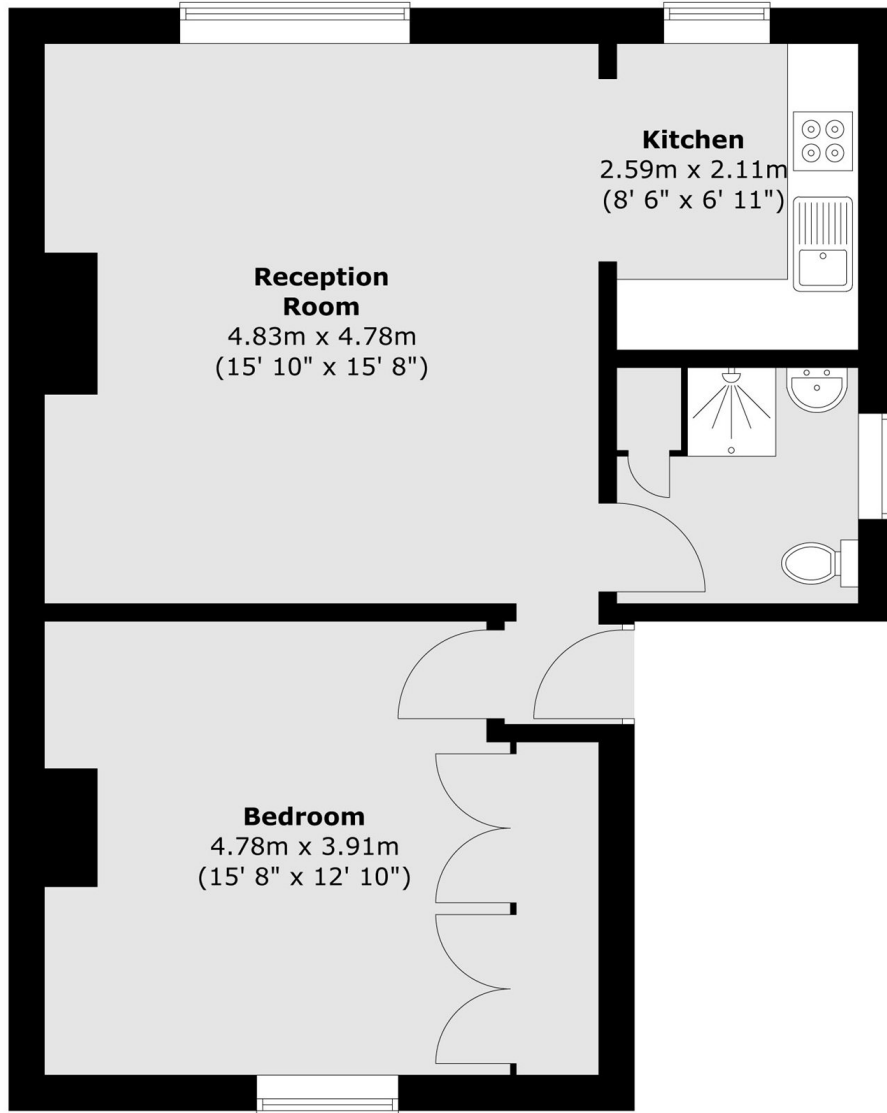

Total area (approx.) : 53.6 sq. m (577 sq. ft)