

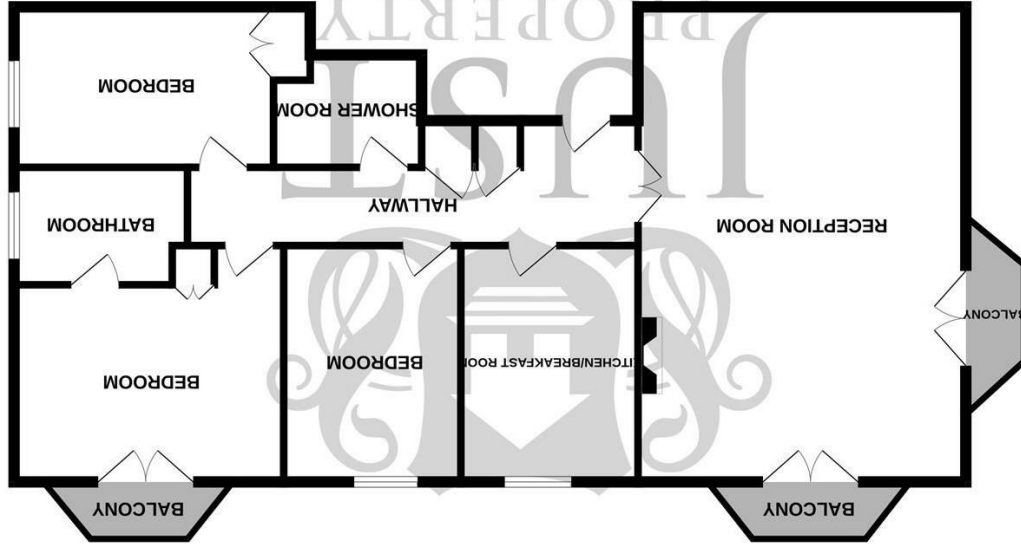

While every attempt has been made to ensure the accuracy of the floorplan contained here, measurements of doors, windows, rooms and other items are approximate and no responsibility is taken for any error, omission or mis-statement. This plan is for illustrative purposes only and should be used as such by any prospective purchaser. The service, quality and appearance shown here are based on the current information available. The service, quality and appearance shown here are based on the current information available. The service, quality and appearance shown here are based on the current information available.



THIRD FLOOR

England & Wales	
EU Directive 2002/91/EC	
Very energy efficient - lower running costs	A (92 plus)
	B (81-91)
	C (69-80)
	D (55-68)
	E (39-54)
	F (21-38)
Not energy efficient - higher running costs	G (1-20)
Current	79
Potential	80

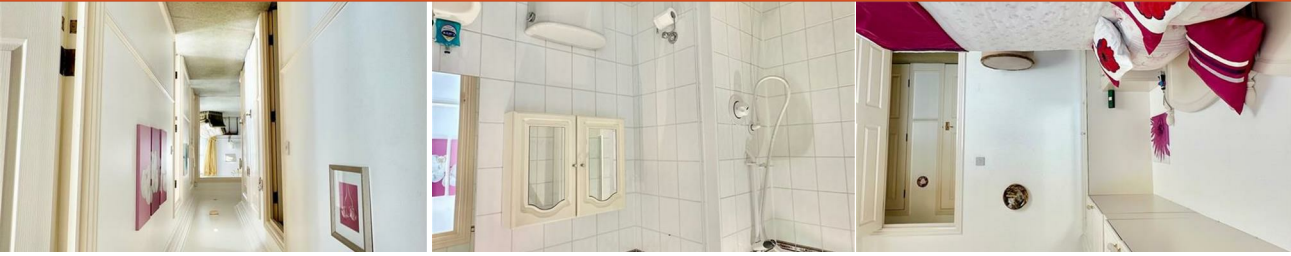

[www.justproperty.net](http://www.justproperty.net)

# FLOORPLANS

Flat 7 Garden Court 15 Devonshire Place, Eastbourne, BN21 4BZ

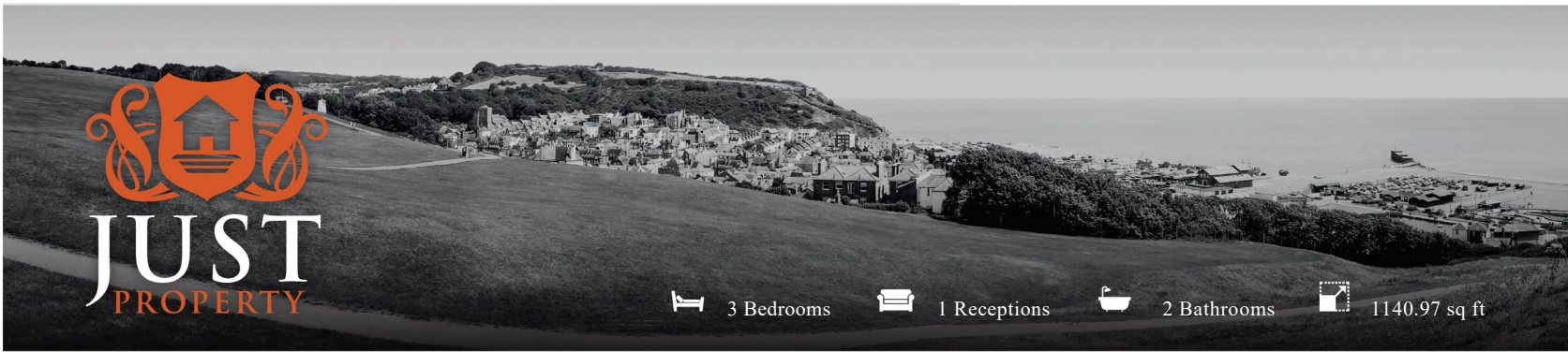

3 Bedrooms | 1 Receptions | 2 Bathrooms | 1140.97 sq ft

Leasehold - Share of Freehold

£399,950

Flat 7 Garden Court 15 Devonshire Place, Eastbourne, BN21 4BZ





3 Bedrooms

1 Receptions

2 Bathrooms

1140.97 sq ft

## PROPERTY DETAILS

### CHAIN FREE

A beautifully presented share of the freehold and exceptionally spacious three-bedroom apartment located on the third floor of this highly sought-after purpose-built block, just a few hundred yards from the seafront, train station, and town centre.

This elegantly appointed apartment forms part of an exclusive development and offers bright, well-planned accommodation. The impressive lounge/ dining room provides access to two separate balconies, allowing for plenty of natural light and outdoor space, while the fitted kitchen/breakfast room is well-equipped with integral appliances and offers a practical and stylish space for dining. The principal bedroom features a third balcony and an en-suite bath & shower room, providing a private retreat, complemented by two further generously proportioned bedrooms and an additional shower room, ideal for family living or guests.

Additional benefits include a secure garage providing convenient parking, lift access to all floors, and direct access to the communal gardens, which offer a peaceful outdoor space for residents.

The Garden Court enjoys a prime location within a highly desirable area of the town, just a short walk from a wide range of shops, restaurants, and local amenities. The award-winning seafront and theatre district are also within easy reach, offering leisure and cultural attractions. For outdoor enthusiasts, the Eastbourne area includes three principal golf courses, while excellent transport links include mainline rail services to London Victoria, Brighton, and Gatwick Airport.

This is a rare opportunity to acquire a superb apartment combining generous accommodation, a prime location, and desirable modern conveniences. Early viewings are highly recommended to fully appreciate the space, style, and lifestyle this property offers. There is a lease of 973 years, and a share of the freehold.



## ROOM DIMENSIONS

Communal Entrance

Residents Lift

Front Door

Hallway

Reception Room  
24'6" x 15'7" (7.47 x 4.75)

Balcony x 2

Kitchen / Breakfast Room  
12'9" x 8'11" (3.89 x 2.72)

Family Shower Room

Bedroom  
15'8" x 12'9" (4.78 x 3.91)

En Suite Bathroom

Balcony

Bedroom

13'8" x 8'0" (4.17 x 2.44)

Bedroom

12'9" x 9'3" (3.89 x 2.82)

Garage

## FEATURES

- Stunning Purpose Built Apartment
- Three Bedrooms
- En suite Bathroom to Principle Bedroom
- Three Balconies
- Balance of 999 Year Lease
- Fantastic Views Towards Sea and South Downs
- Residents Lift
- Garage Parking
- Share of the Freehold
- CHAIN FREE

