



CHATSWORTH ROAD, NW2

£600,000

This superb, two-bedroom apartment is situated on the first floor of a charming period conversion, comprising a spacious reception room, separate kitchen with direct access to a large private roof terrace, two

Two bedrooms

Large, private terrace

Separate kitchen

Communal garden

Great transport links

Period conversion

@marshandparsons
marshandparsons.co.uk

MARSH &
PARSONS

STEP INSIDE CHATSWORTH ROAD

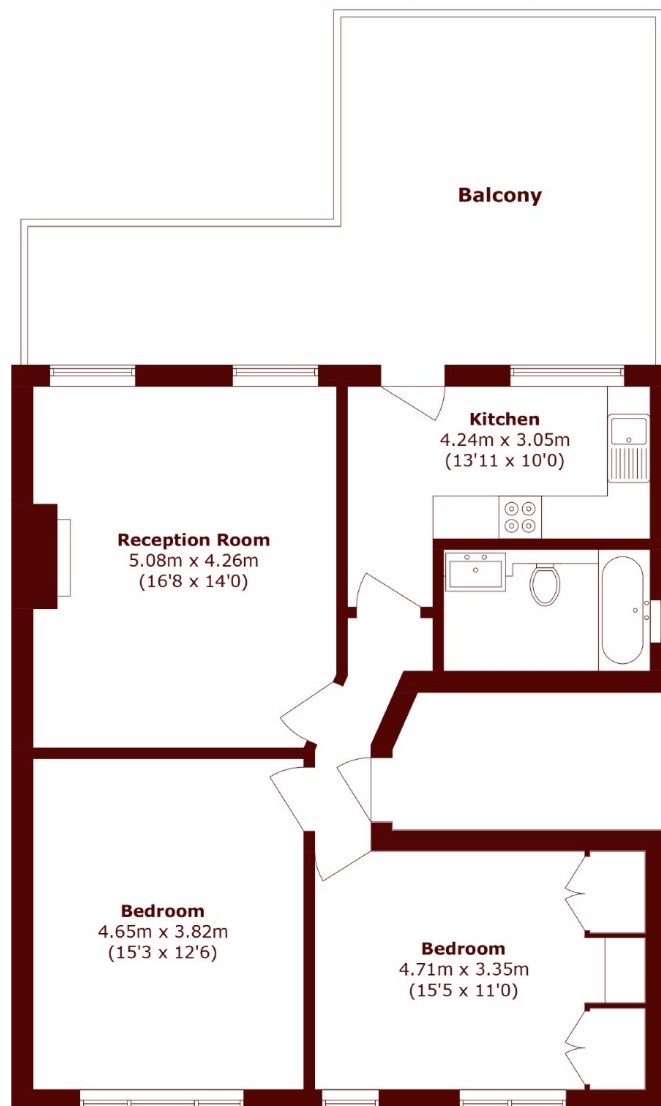

Total area (approx.): 75.8 sq. m (815.9 sq. ft)
Balcony area (approx.): 30.1 sq. m (323.9 sq. ft)

Willesden Green
020 8451 0420

Energy Rating: C We aim to make our particulars both accurate and reliable. However, they are not guaranteed; nor do they form part of an offer or contract. If you require clarification on any points then please contact us, especially if you're traveling some distance to view. Please note that appliances and heating systems have not been tested and therefore no warranties can be given as to their good working order

**MARSH &
PARSONS**