



Avondale Road
London, SW14

CHESTERTONS





This beautifully refurbished ground-floor, two-bedroom maisonette offers stylish, turnkey living with the added benefit of a wonderful private garden and patio—perfect for relaxing outdoors or entertaining family and friends.

Pet-friendly (the current owner has a dog), the property is ideally located just moments from the Thames Path, offering picturesque riverside walks, excellent running routes, and plenty of opportunities for dog walking.

Finished to an exceptional standard throughout, this immaculate home is ready to move straight into. Approached via a well-maintained front garden, the property has its own private entrance. Inside, there are two generously sized double bedrooms and a useful internal storage cupboard. To the rear, the thoughtfully designed living accommodation comprises a comfortable reception room, a separate eat-in kitchen, a contemporary shower room, and direct access to the private garden and patio.

Situated on Mortlake High Street, just moments from the River Thames, the property enjoys easy access to a fantastic selection of cafés, restaurants, pubs, and local amenities. It is also within the catchment area of highly regarded schools, including St. Mary Magdalen's and Thomson House. Excellent transport links are available from both Mortlake and Barnes Bridge stations, providing convenient connections into central London.

- Private Garden
- Share of Freehold
- Two Double Bedrooms
- Refurbished Condition

Asking Price £650,000

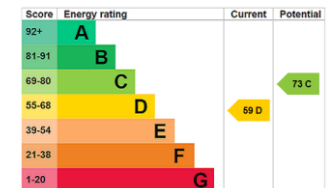

Tenure: Share of Freehold
Service Charge: £0
Ground Rent: £0
Local Authority: London Borough of Richmond upon Thames
Council Tax Band: D

Chestertons East Sheen Sales
 254A Upper Richmond Road West
 East Sheen
 London
 SW14 8AG
 sheen@chestertons.co.uk
 020 8104 0580

Avondale Road, SW14



○ - Ceiling Height

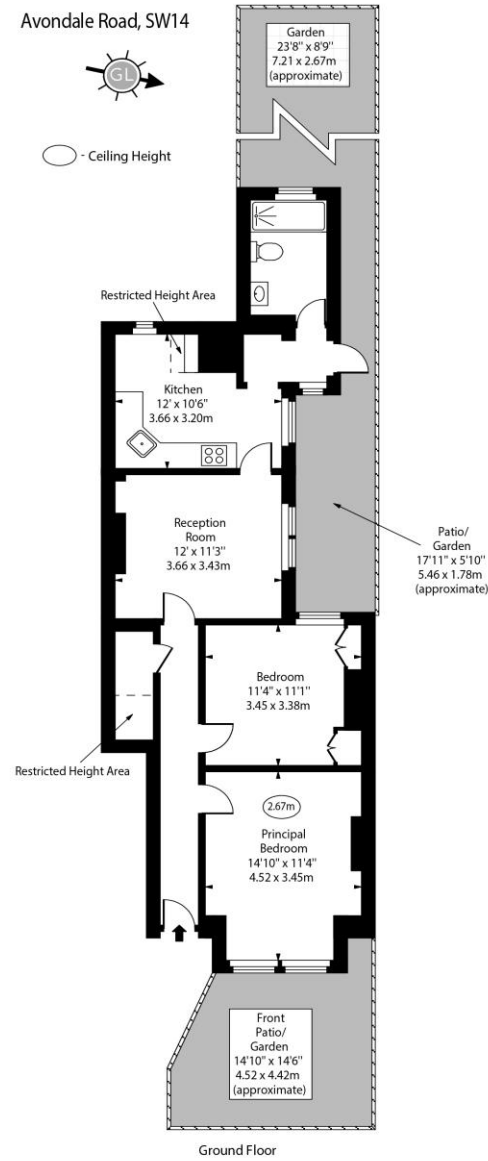

Approx Gross Internal Area 715 Sq Ft - 66.42 Sq M

Approx. Floor Area Including Restricted Heights 733 Sq Ft - 68.10 Sq M

Chesterton UK Services Limited trading as Chestertons for themselves and for the vendor of this property whose agents they are, give notice that (i) these particulars do not constitute any part of an offer or contract, (ii) all statements contained within these particulars are made without responsibility on the part of Chestertons or the vendor, (iii) whilst made in good faith, none of the statements contained within these particulars are to be relied upon as a statement or representation of fact, (iv) any intending purchasers must satisfy themselves by inspection or otherwise as to the correctness of each of the statements contained within these particulars, (v) the vendor does not make or give either Chestertons or any person in their employment any authority to make or give representation or warranty whatsoever in relation to this property. Wide angle lenses may be used. ©Copyright Chestertons | Chesterton UK Services Limited | Registered Office 5th Floor, The Lantern, 75 Hampstead Road, London, NW1 2PL Registered Company Number 05334580.



This paper is
100% recyclable