



Wexford Road, SW12

£1,500 Per calendar month

A well-presented one bedroom flat situated on the second floor of an attractive Victorian conversion. The property has a generous sized reception room with feature fireplace, separate kitchen and a shower room.

Wexford Road is an attractive tree lined street within walking distance to both Wandsworth Common train station and Balham train and tube station. The amenities of Northcote Road and Bellevue Road are also nearby.

Features

Victorian Conversion
One Bedroom Flat
Well-Presented
Desirable Location
Spacious Reception Room
Wandsworth Common

Wexford Road,
London, SW12

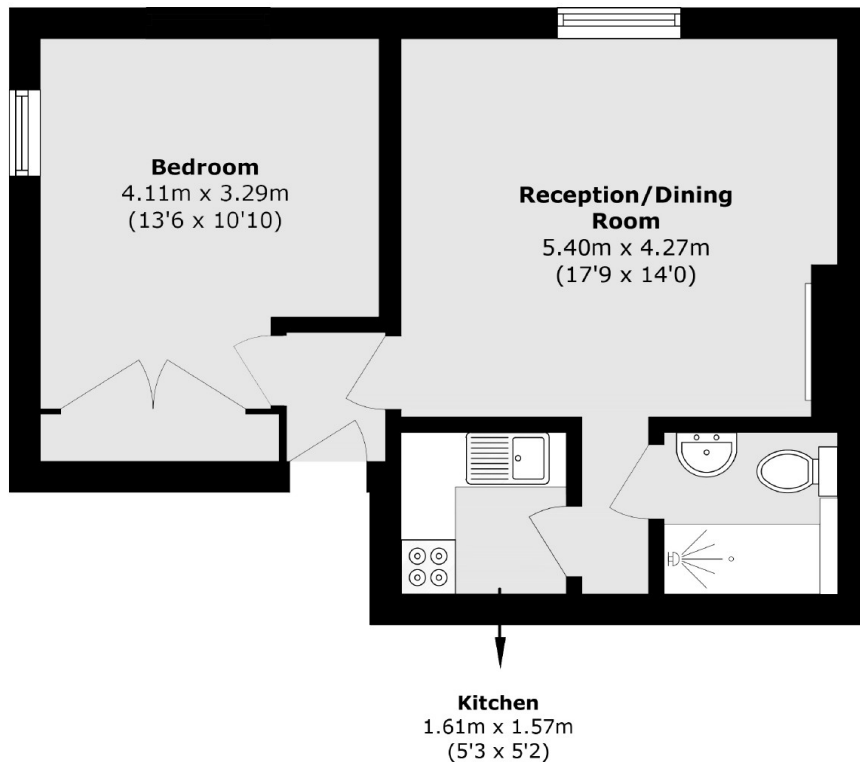

Total area (approx.): 37.2 sq. m (400.4 sq. ft)

Dexters

Clapham South & Balham
9 Cavendish Parade
London
SW4 9DP
Lettings
0208 675 6750

Energy Rating: E. We aim to make our particulars both accurate and reliable. However they are not guaranteed; nor do they form part of an offer or contract. If you require clarification on any points then please contact us, especially if you're traveling some distance to view. Please note that appliances and heating systems have not been tested and therefore no warranties can be given as to their good working order.

 **RICS** | Regulated
Estate Agent
and Letting Agent

[dexters.co.uk](https://www.dexters.co.uk)