



Albertine Road, Langley, Maidstone, ME17 3UP
Guide Price £300,000



GUIDE PRICE £300,000 TO £325,000

ESTABLISHED FORWARD CHAIN

IMMACULATE TWO BEDROOM HOME WITH PRIVATE DRIVEWAY FOR TWO CARS

This beautifully presented two-bedroom home offers a superb combination of style and practicality, making it an ideal choice for first-time buyers or those looking to downsize. The ground floor comprises an entrance hall, a convenient cloakroom, and a bright open-plan kitchen/living space, with French doors leading out to the rear garden.

Upstairs, the property features two generously sized bedrooms, with the main bedroom benefiting from fitted wardrobes, along with a modern family bathroom complete with a shower over the bath.

Externally, the rear garden is well maintained and of a good size, offering a patio seating area, lawns, and gated access to the private driveway, which provides off-road parking for two vehicles.

The property is well positioned for access to local amenities and transport links. Headcorn train station is approximately a ten-minute drive away, offering regular services to London and the coast. Maidstone town centre is also within easy reach, providing a wide selection of shops, restaurants, and leisure facilities, along with popular attractions including Leeds Castle and Mote Park.

Viewing is highly recommended to fully appreciate the quality and convenience this home has to offer. Please contact Page & Wells to arrange your viewing.



GROUND FLOOR

Entrance Hall

Downstairs WC

Lounge/Kitchen/Dining Area 25'2" x 13'4" (7.69m x 4.08m)

FIRST FLOOR

Bedroom 1 13'4" x 11'1" (4.08m x 3.38m)

Bedroom 2 13'5" x 8'9" (4.09m x 2.69m)

Bathroom

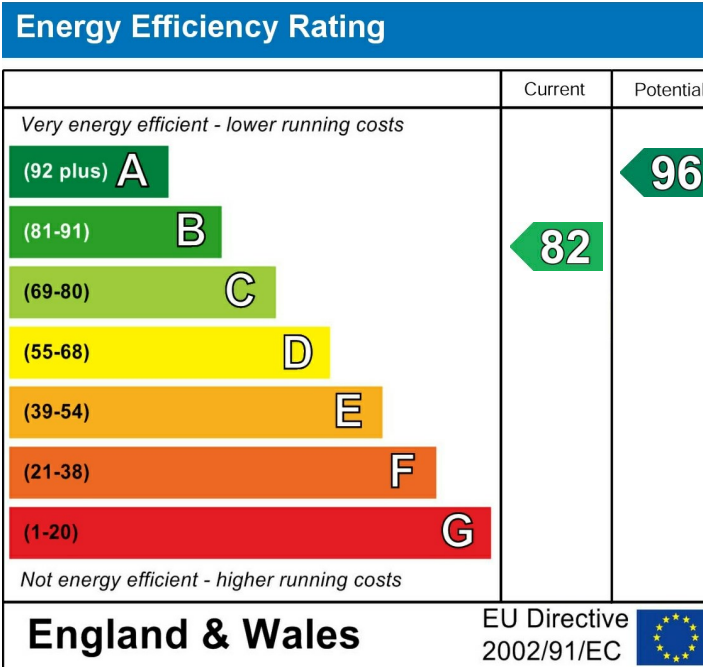

Page & Wells limited for themselves and for the vendors of this property whose agents they are give notice that: 1. These particulars do not constitute any part of, an offer or a contract. 2. All statements contained in these particulars as to this property are made without responsibility on the part of Page & Wells Limited or the Vendor. 3. None of the statements contained in these particulars as to the property is to be relied on as statements or representations of fact. 4. Any intending purchaser must satisfy himself by inspection or otherwise as to the correctness of each of the statements contained in these particulars. 5. The vendor does not make or give, and neither Page & Wells Limited nor any person in their employment has any authority to make or give any representation whatsoever in relation to this property. These particulars are supplied on the understanding that all negotiations are carried out throughout Page & Wells Limited. Properties with a reference prefixes EAA are those which Page & Wells Limited disclose an interest in accordance with the provisions of the Estates Agents Act 1979

Albertine Road, Langley, Maidstone, Kent
 Approximate Gross Internal Area
 676 Sq Ft/63 Sq M

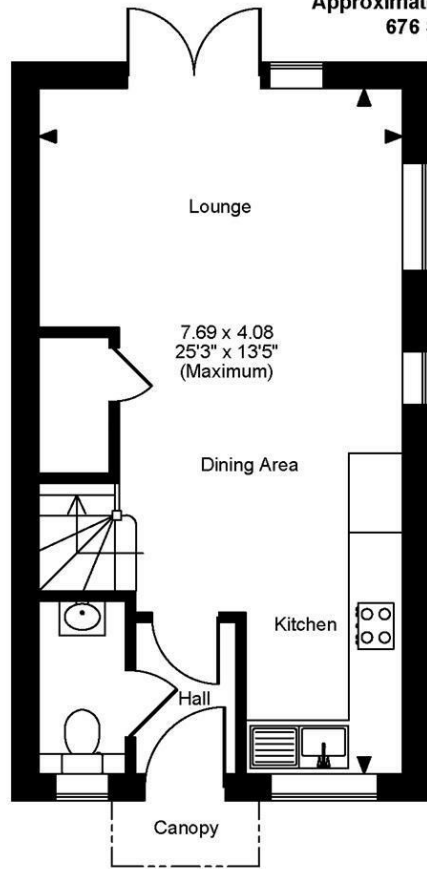
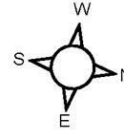

Ground Floor

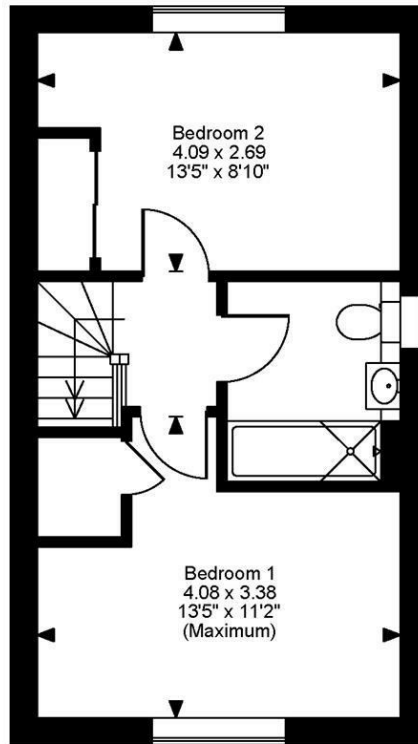

First Floor

FOR ILLUSTRATIVE PURPOSES ONLY - NOT TO SCALE

The position & size of doors, windows, appliances and other features are approximate only.

© ehouse. Unauthorised reproduction prohibited. Drawing ref. dig/8687602/SAP

