



**39 Whitebrook Court, Sale, M33 3NL**

£130,000

[www.jordanfishwick.co.uk](http://www.jordanfishwick.co.uk)





# Jordan fishwick

- No onward chain
- Modern bathroom
- Close to local amenities
- Council tax band B and EPC TBC
- 1 spacious bedroom
- Over 60s flat
- Easy access to transport

Nestled on the charming Whitehall Road in Sale, this delightful retirement flat offers a perfect blend of comfort and convenience. The property is part of a well-maintained development designed specifically for those seeking a peaceful and supportive living environment.

Upon entering, you will find a welcoming reception room that provides a warm and inviting space for relaxation or entertaining guests. The flat features one spacious bedroom, ideal for restful nights, and a well-appointed bathroom that caters to your daily needs.

This property is particularly appealing as it comes with no onward chain, allowing for a smooth and hassle-free transition for prospective buyers. The location is superb, with easy access to local amenities, public transport, and beautiful parks, making it an ideal choice for those looking to enjoy a vibrant community while maintaining a tranquil lifestyle.

This flat on Whitehall Road presents an excellent opportunity to embrace comfortable retirement living in a sought-after area. Do not miss the chance to make this lovely property your new home.

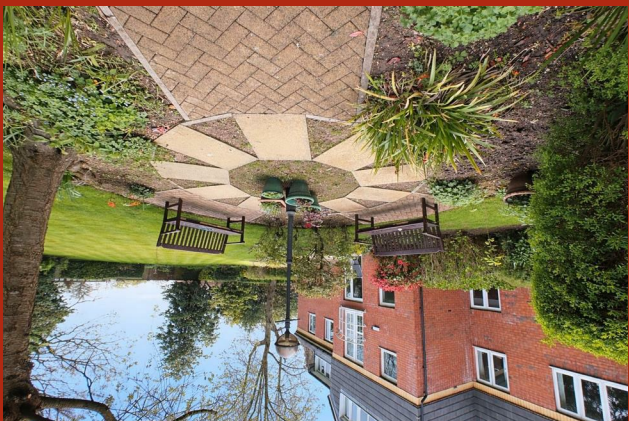



## Floor Plans

GROUND FLOOR (42.8 sq.m.) approx.  
461 sq.ft.

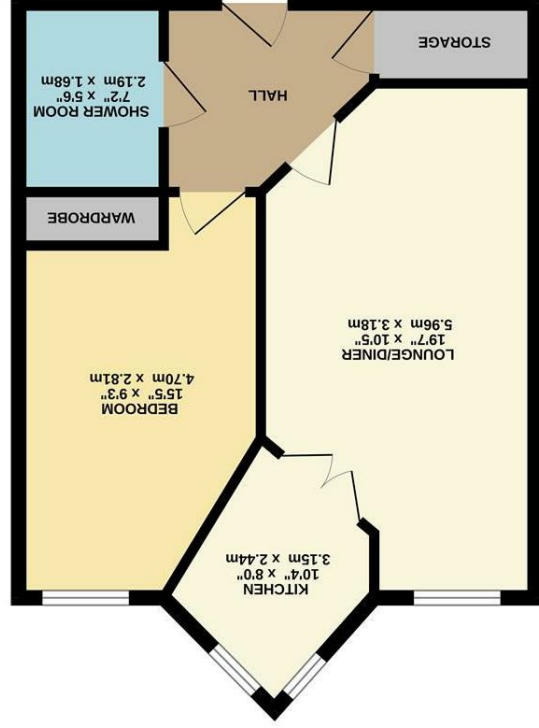

## Viewing

Please contact our Sale Office on 0161 962 2828 if you wish to arrange a viewing appointment for this property or require further information.

The particulars are set out as a general outline only for the guidance of intended purchasers or lessees, and do not constitute, any part of a contract. Nothing in these particulars shall be deemed to be a statement that the property is in good structural condition or otherwise nor that any of the services, appliances, equipment or facilities are in good working order. Purchasers should satisfy themselves of this prior to purchasing.

## Location Map

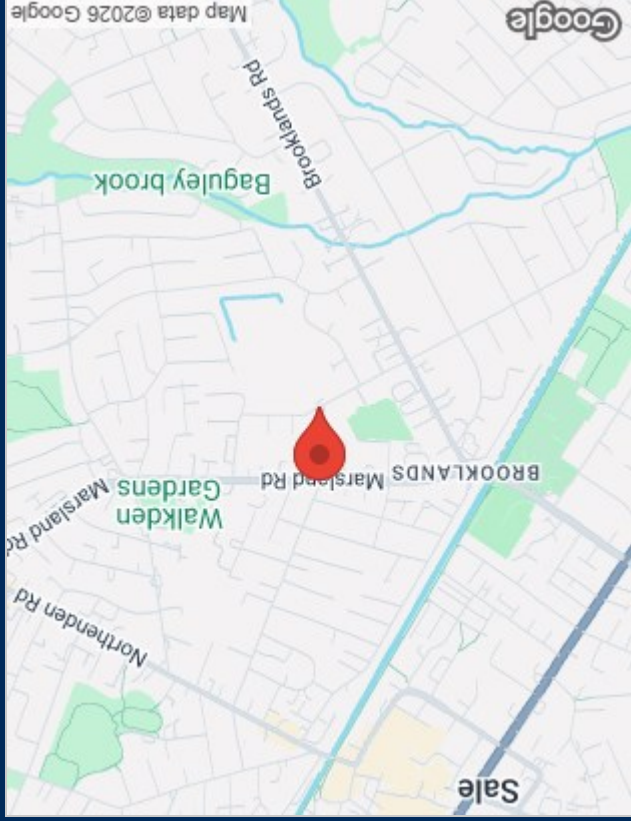

## Energy Performance Graph

