



# Parklands Park, School Lane, Evesham, Worcestershire, WR11 2QJ

£130,000

🛏️ 2 🚿 1 🚗 1



- Detached Park Home
- Bright bay-fronted lounge
- Modern refitted kitchen
- Private driveway parking
- Popular residential park setting
- Two double bedrooms
- Feature fireplace focal point
- Contemporary shower room
- Recently Refurbished
- No stamp duty to pay



Situated on the popular Parklands Park in Evesham, this well-proportioned two-bedroom park home occupies a generous plot and offers comfortable, low-maintenance single-storey living. The property has been recently refurbished and features a spacious and light-filled lounge/dining room with bay window and feature fireplace, alongside a modernised kitchen fitted with stylish shaker-style units and ample worktop space, with direct access outside. There are two good-sized bedrooms and a contemporary shower room with curved glass enclosure. Externally, the home benefits from low-maintenance gardens, providing excellent outdoor space and scope for further enhancement. A private driveway offers convenient off-street parking. Ideally positioned within a peaceful residential park, yet within easy reach of Evesham town centre and its range of amenities.

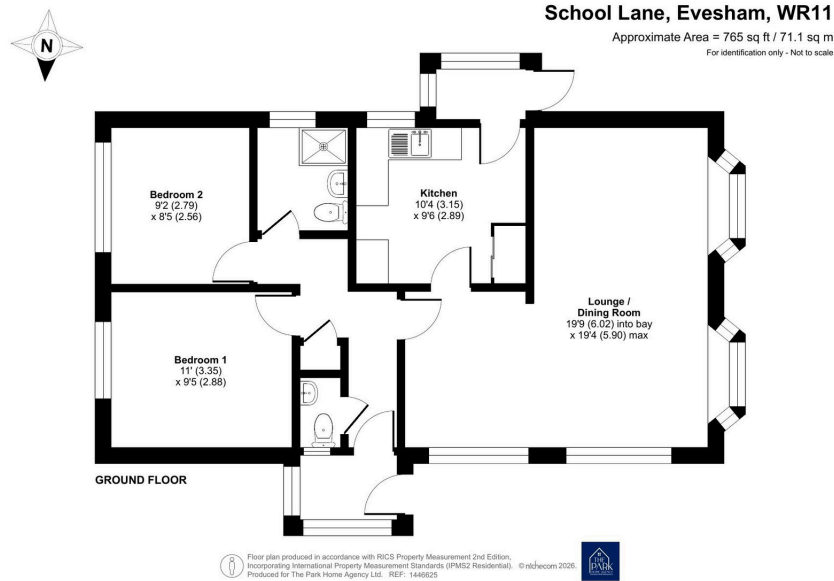

01793 230185  
 sales@theparkhomeagency.co.uk

Agents Notes: All measurements are approximate and quoted in metric with imperial equivalents and for general guidance only and whilst every attempt has been made to ensure accuracy, they must not be relied on. The fixtures, fittings and appliances referred to have not been tested and therefore no guarantee can be given that they are in working order. Internal photographs are reproduced for general information and it must not be inferred that any item shown is included with the property. For a free valuation, contact the numbers listed on the brochure