



The Broadway

Thorpe Bay, Southend-on-Sea

- SECOND FLOOR FLAT
- TWO DOUBLE BEDROOMS
- GOOD SIZE LOUNGE
- KITCHEN WITH WORKTOPS AND CUPBOARDS

Guide Price £250,000

****NEW LEASE ON COMPLETION**** Second floor purpose built flat with two double bedrooms. The property has the benefit of gas central heating and double glazed. Located above shops on the popular Thorpe Bay Broadway shopping centre. Thorpe Bay seafront and railway stations are nearby amenities.





****NEW LEASE ON COMPLETION**** Second floor purpose built flat with two double bedrooms. The property has the benefit of gas central heating and double glazed. Located above shops on the popular Thorpe Bay Broadway shopping centre. Thorpe Bay seafront and railway stations are nearby amenities.

LANDING

External stairs to first floor flat roof area with door to flat and stairs up to second floor accommodation. Landing with built in storage cupboard. Glazed door to hall.

SQUARE HALL

Built in storage cupboard. Radiator.

LOUNGE

17' x 12' (5.18m x 3.66m) Double glazed windows to front. Radiator. Glass partition and glazed door to kitchen.



KITCHEN

15' 5" x 6' 4" (4.70m x 1.93m) Range of worktops and cupboards. Central heating timer. Built in cupboard. Double glazed window to rear. Extractor fan. Plumbing for washing machine.

BEDROOM ONE

13' 9" x 11' 8" (4.19m x 3.56m) Double glazed windows to front. Radiator.

BEDROOM TWO

11' 7" x 11' 8" (3.53m x 3.56m) (max) Double glazed window to rear. Radiator.

BATHROOM/WC

White suite comprising panelled bath, pedestal wash hand basin and low flush W.C. Half tiled walls. Obscure double glazed window to rear. Radiator.

TENURE

NEW LEASE ON COMPLETION

GROUND RENT - £0

SERVICE CHARGE - £0

COUNCIL TAX - B

EPC - D



These particulars are accurate to the best of our knowledge but do not constitute an offer or contract. Photos are for representation only and do not imply the inclusion of fixtures and fittings. The floor plans are not to scale and only provide an indication of the layout.

First Floor

Approx. 70.2 sq. metres (756.0 sq. feet)



Ground Floor

Approx. 2.0 sq. metres (21.7 sq. feet)

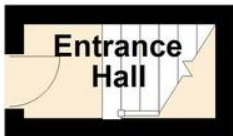

Total area: approx. 72.3 sq. metres (777.8 sq. feet)

Regulated by RICS

t. 01702 34 11 77
More than an estate agent
www.hairandson.co.uk

Residential Sales
190 London Road
Southend-On-Sea
Essex SS1 1PJ

