



Jordan fishwick

Barlow Moor Road
Manchester



**Barlow Moor Road
Manchester M21 8HA**
£2,500 Per Calendar Month



The Property

**** AVAILABLE NOW **** This well presented newly renovated extended three double bedroom semi detached property is perfectly placed within only a short stroll of Chorlton Village, highly regarded schools and all local amenities. This spacious and light accommodation benefits from a large enclosed private rear garden as well as the front offering gated parking providing ample off road parking. The property is conveniently located for the Metrolink, Chorlton Village and Chorlton Green, where you can enjoy the ever popular Beech Road with its cute shops, cafes and bars. The property comprises: large and light entrance hallway, lounge with large bay window, extended open plan large kitchen with additional space for dining and additional reception space with modern fitted units and central island, cloakroom/wc. To the first floor there are three good sized double bedrooms, large family bathroom fitted with a modern suite. Double glazing and gas central heating have been installed throughout. Externally, to the front of the property a gated drive, providing ample off road parking. To the rear, a fenced and enclosed garden laid to new lawn plus a paved patio area.

***** To arrange a viewing please call 0161 860 4444 *****

Directions

- Council Tax C - EPC C
- Newly renovated Semi detached
- Three Double Bedroom
- Unfurnished
- Secure off road parking
- Close to Transport links
- Available Now

Postcode - M21 8HA
EPC Rating - C
Floor Area - sq ft
Local Authority - Manchester
Council Tax - C



GROUND FLOOR
687 sq.ft. (63.8 sq.m.) approx.

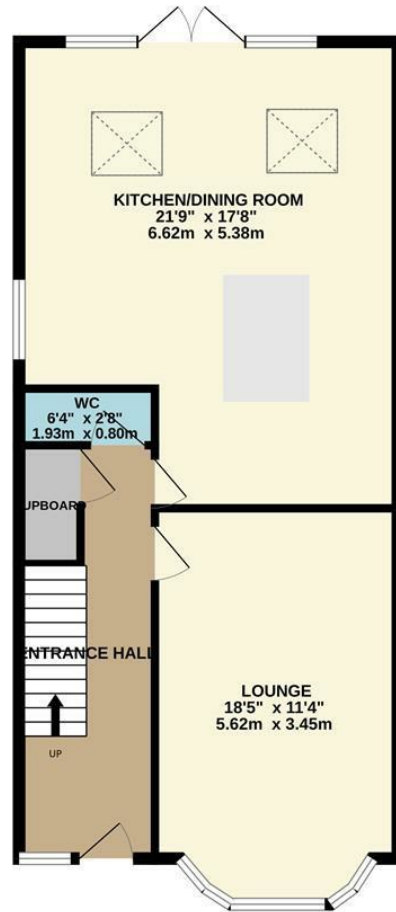

1ST FLOOR
540 sq.ft. (50.1 sq.m.) approx.

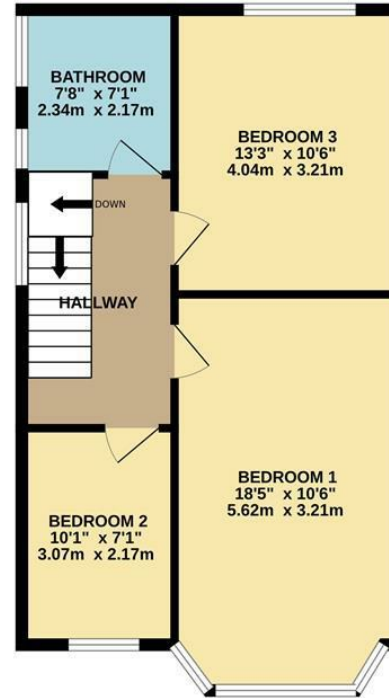

TOTAL FLOOR AREA: 1226 sq.ft. (113.9 sq.m.) approx.

Whilst every attempt has been made to ensure the accuracy of the floorplan contained here, measurements of doors, windows, rooms and any other items are approximate and no responsibility is taken for any error, omission or mis-statement. This plan is for illustrative purposes only and should be used as such by any prospective purchaser. The services, systems and appliances shown have not been tested and no guarantee as to their operability or efficiency can be given.
Made with Metropix ©2026



These particulars are believed to be accurate but they are not guaranteed and do not form a contract. Neither Jordan Fishwick nor the vendor or lessor accept any responsibility in respect of these particulars, which are not intended to be statements or representations of fact and any intending purchaser or lessee must satisfy himself by inspection or otherwise as to the correctness of each of the statements contained in these particulars. Any floorplans on this brochure are for illustrative purposes only and are not necessarily to scale.

Offices at: Offices at Chorlton, Didsbury, Disley, Hale, Glossop, Macclesfield, Manchester Deansgate, Manchester Whitworth Street, New Mills, Sale, Wilmslow and Withington

410-412 Barlow Moor Road, Chorlton, Manchester, M21

01618604444 ^{8AD}

chorlton@jordanfishwick.co.uk
www.jordanfishwick.co.uk