



SAMUEL WOOD

3 Willow Grove, Alexandra Park, Craven Arms, Shropshire, SY7 9AE

£725 Per Month







## 3 Willow Grove

Alexandra Park, Craven Arms, Shropshire, SY7 9AE



MANAGED BY SAMUEL WOOD. Ground floor apartment situated close to the town centre of Craven Arms. Allocated parking.



MANAGED BY SAMUEL WOOD

Situated close to the town centre of Craven Arms is this 2 bedroomed ground floor apartment. The property has been newly decorated throughout.

Gas centrally heated accommodation comprises of entrance hall to open plan living/dining room leading through to kitchen. Further hallway off which is bedroom 1 with en-suite, bedroom 2 and further bathroom. Allocated parking space to rear.











## Directions

Available on a min 12 months tenancy.  
Unfurnished  
No smoking/vaping.  
No Pets.  
EPC - C  
Council Tax Band – A  
Utilities (mains gas, mains electric, mains water, mains drainage)  
Parking situation – off road parking for 1 vehicle











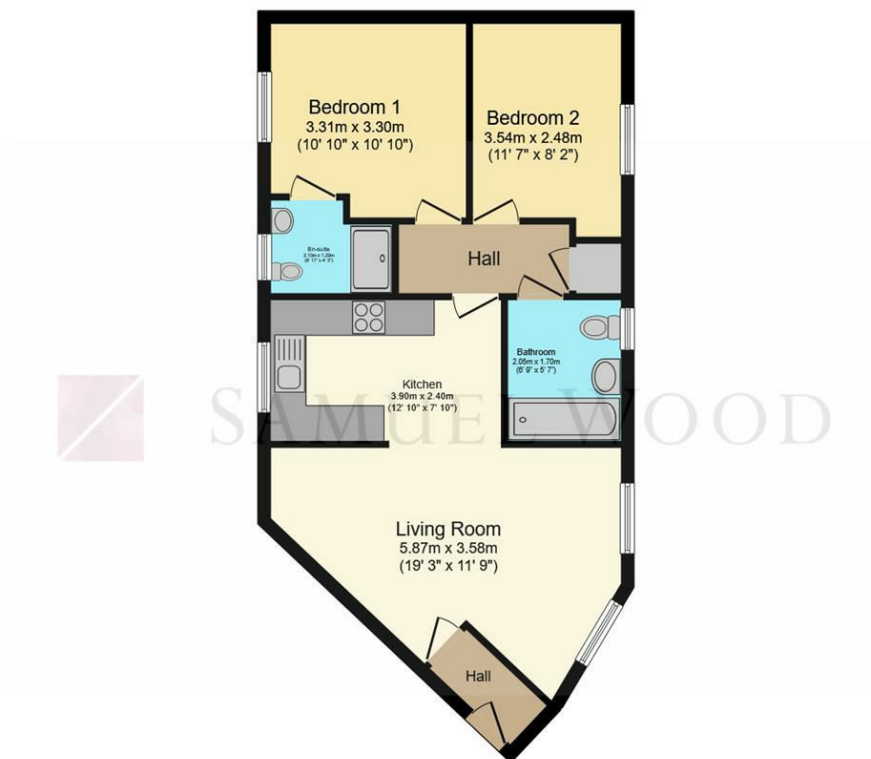

**Floor Plan**  
Floor area 61.9 sq.m. (666 sq.ft.)

**Total floor area: 61.9 sq.m. (666 sq.ft.)**

This floor plan is for illustrative purposes only. It is not drawn to scale. Any measurements, floor areas (including any total floor area), openings and orientations are approximate. No details are guaranteed, they cannot be relied upon for any purpose and do not form any part of any agreement. No liability is taken for any error, omission or misstatement. A party must rely upon its own inspection(s). Powered by [www.Propertybox.io](http://www.Propertybox.io)

We take every care in preparing our sales details. They are checked and usually verified by the Vendor. We do not guarantee appliances, alarms, electrical fittings, plumbing, showers etc. You must satisfy yourself that they operate correctly. Room sizes are approximate; they are usually taken in metric and converted to imperial. Do not use them to buy carpets or furniture. We cannot verify the tenure, as we do not have access to the legal title; we cannot guarantee boundaries or rights of way so you must take the advice of your legal representative. No person in the employment of or representing Samuel Wood has any authority to make any representation or warranty whatever in relation to this property. If there is any point which is of particular importance to you, please contact the office and we will be pleased to check the information. Do so particularly if contemplating travelling some distance to view. Applicants are advised that the majority of our shots are taken with a wide angle lens.

CONTEMPORARY AGENCY • TRADITIONAL VALUES

2 Shoplatch, Shrewsbury, Shropshire, SY1 1HF  
Tel: 01743 272710 | [shrewsbury@samuelwood.co.uk](mailto:shrewsbury@samuelwood.co.uk)