



1 Bedroom  
Flat - Purpose Built  
located in Spa  
Court, Kings  
Esplanad

Asking price £480,000



## Spa Court, Kings Esplanade, Hove, BN3 2WS

Approximate Gross Internal Area = 65.6 sq m / 706 sq ft

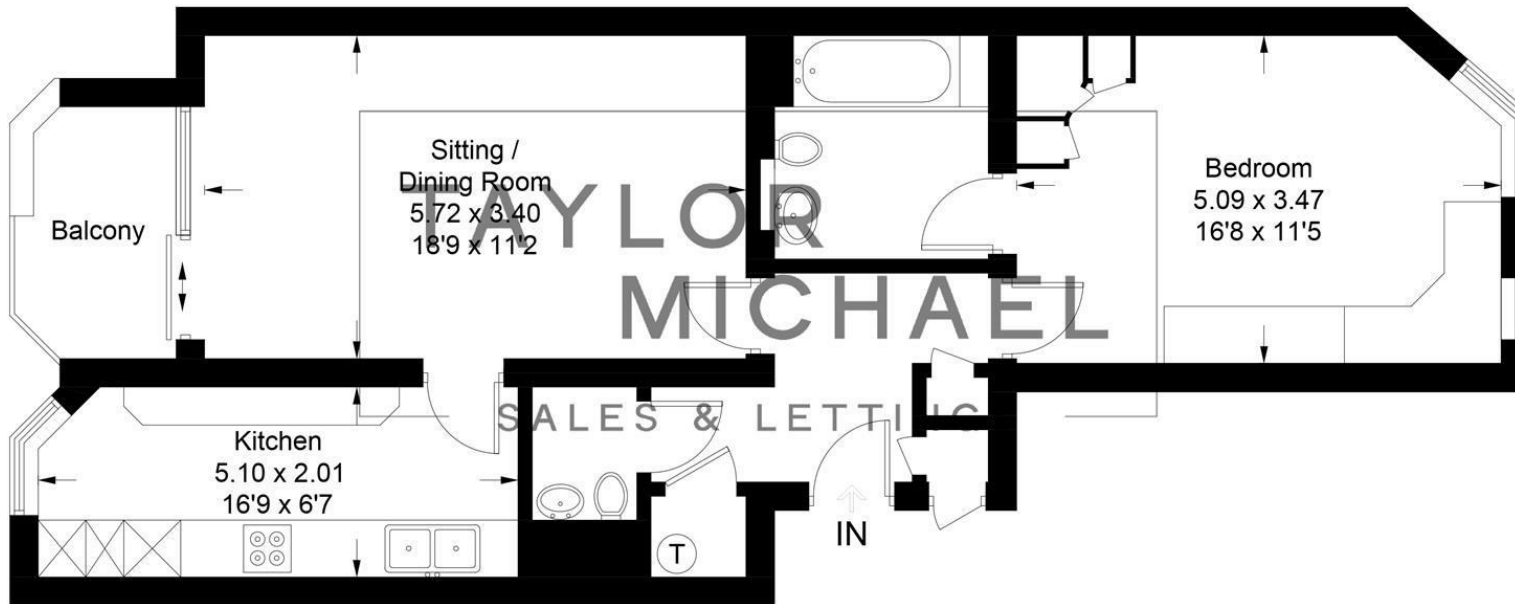

**Sixth Floor**

Illustration for identification purposes only, measurements are approximate, not to scale.  
Imageplansurveys @ 2025

### DESCRIPTION

Positioned on the sixth floor of this highly regarded purpose-built seafront development, this exceptional one-bedroom apartment enjoys uninterrupted, direct sea views that are quite simply unrivalled. With a private balcony, allocated parking, lift access, and a share of freehold, this property represents a rare opportunity to acquire a premium coastal home in one of Hove's most sought-after locations.

### CONTACT

62 Church Road  
Hove  
East Sussex  
BN3 2FP

T: 01273 600 100  
<https://taylormichael.agency/>

**TAYLOR  
MICHAEL**