



**POOLE
TOWNSEND**

Mint Dale, Kendal

£180,000

3 1 2



- End Of Terrace House
- 3 Bedrooms
- 1 Well-Proportioned Reception Room
- 1 Bathroom
- Timber Shed & Summerhouse
- Enclosed Rear Garden
- Popular Residential Cul-De-Sac
- No Onward-Chain
- Council Tax Band: B
- Tenure: Freehold



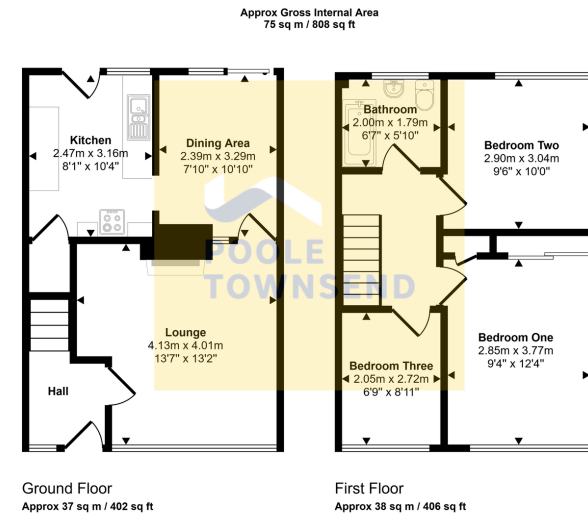

This floorplan is only for illustrative purposes and is not to scale. Measurements of rooms, doors, windows, and any items are approximate and no responsibility is taken for any error, omission or mis-statement. Icons of items such as bathroom suites are representations only and may not look like the real items. Made with Made Snappy 360.

Situated in a popular residential cul-de-sac on the northern edge of Kendal town centre, this three-bedroom home is offered with no onward chain and presents an excellent opportunity to update and personalise to suit individual tastes. The accommodation includes a generous lounge with gas fire, dining room with sliding patio doors opening onto the garden, and a fitted kitchen with a range of storage units and useful understairs storage. To the first floor are two generous double bedrooms, a well-proportioned single bedroom ideal as a home office or study, and a family bathroom. Externally, the property benefits from an attractive enclosed rear garden featuring a patio seating area, lawn, pond, colourful shrub borders, a timber shed and a summerhouse, both included in the sale. Conveniently located close to local amenities, supermarkets and Queen Katherine School, this property is ideally suited to families, first-time buyers and investors alike.

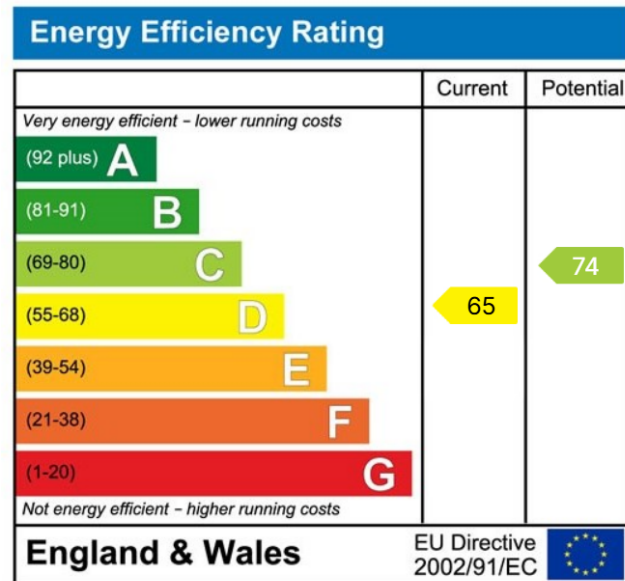

Visit us at
www.pooletownsend.co.uk
enquiries@pooletownsend.co.uk

We are open
 Monday – Friday 9.00 – 5.00
 Saturday 9.00 – 1.00

Barrow 01229 811811
 Ulverston 01229 588111
 Grange 015395 33316
 Kendal 01539 734455
 Milnthorpe 015395 62044