



Chatham Road, KT1

£1,050,000

A spacious semi-detached period four-bedroom Family Home with West facing Garden. This well-presented four-bedroom family home offers generous living accommodation throughout, plenty of character and excellent potential to extend (STPP).

Chatham Road is a popular tree lined road ideally located for Norbiton station, the River Thames and Richmond Park's Kingston Gate. There is also easy access to both Richmond and Kingston town centres.

Features

- Semi Detached
- Beautiful Period Property
- Four Bedrooms
- Great Location
- Potential to Extend STPP
- Chain Free



Chatham Road, KT1

As you enter the property, you are welcomed by a spacious entrance hall. To the front is a bright and comfortable living room featuring a large bay window and an attractive feature fireplace. Towards the centre of the home is a good-sized fitted kitchen with direct access to the rear garden, along with a modern family bathroom. At the rear of the property is a second reception room, ideal as a family room or dining room, complete with a feature fireplace and double doors opening onto the private west-facing garden, making it a great space for entertaining or relaxing.

Upstairs, the property offers four bedrooms, including a generous principal bedroom, two further double bedrooms and a fourth single bedroom, which would also make an ideal home office, nursery or playroom. There is also a family bathroom and separate WC.

Outside, there is a low-maintenance paved front garden and a lovely private west-facing rear garden, perfect for enjoying the afternoon and evening sun.

The property retains many attractive period features while benefiting from double glazing throughout. With spacious accommodation and scope to extend (STPP), this is an ideal home for growing families looking to make a property their own



Chatham Road, Kingston Upon Thames, KT1

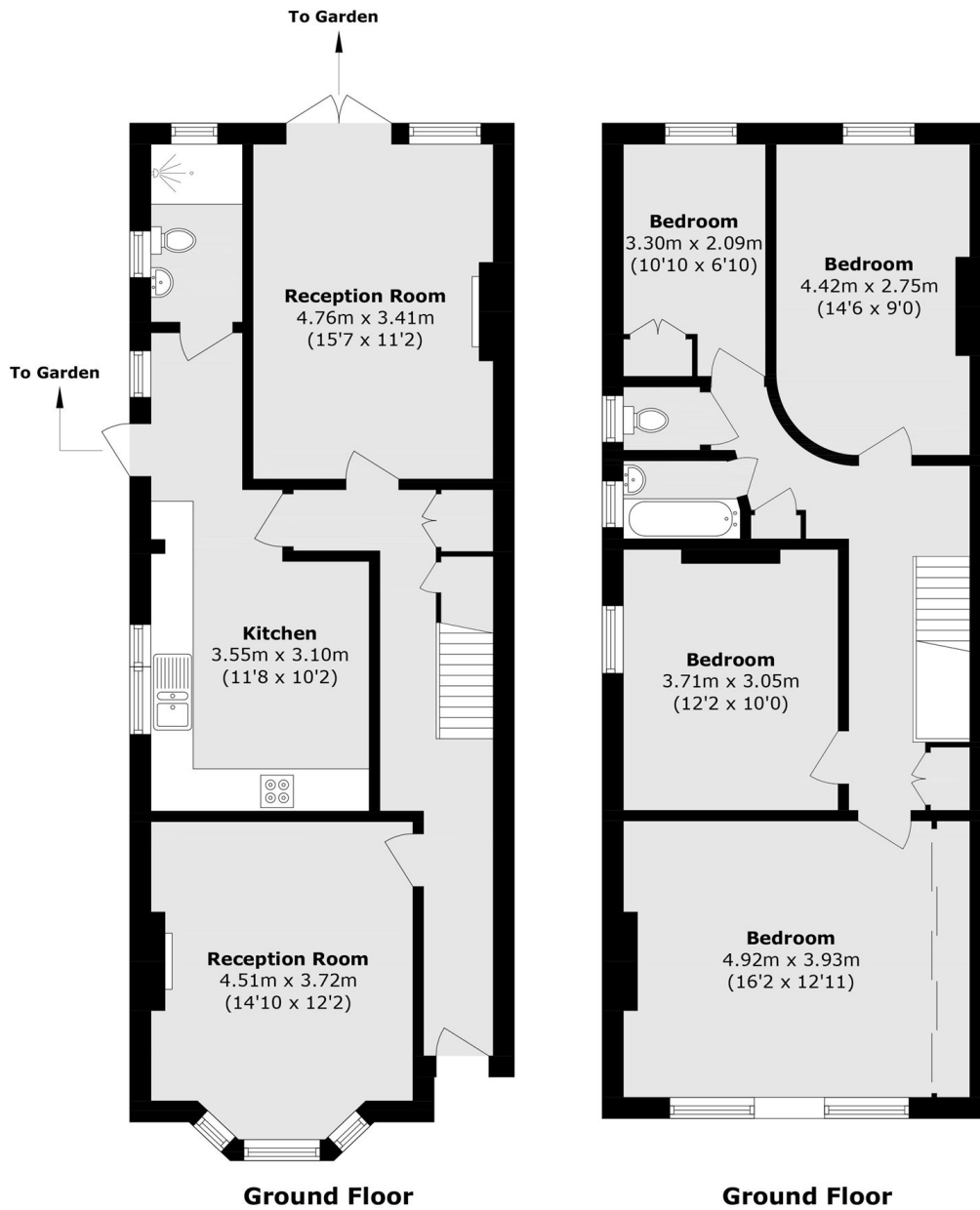

Total area (approx): 133.0 sq. m (1431.6 sq. ft)