



Lupus Street, SW1V

£775,000

Dexters



Lupus Street, SW1V

This beautifully presented two bedroom garden flat offers an exceptional blend of space, character, and potential, all accessed via its own private entrance. Finished to a high standard throughout, the property boasts a superb double reception room with generous proportions, creating an elegant entertaining space alongside comfortable day-to-day living.

The accommodation further comprises a well-appointed kitchen, a stylish bathroom, and two well-sized bedrooms, all maintained in excellent condition throughout. A particular highlight of the property is the impressive larger-than-average private garden, offering a rare and tranquil outdoor retreat ideal for al-fresco dining and entertaining.

In addition, the property benefits from granted planning permission for a second bathroom, presenting an exciting opportunity to further enhance both convenience and value.

The apartment is located on Lupus Street close to St. Georges Square with access to its public gardens. There are many local shops and restaurants all within easy reach. There are excellent transport links at Pimlico underground station (Victoria Line) and Victoria Station.

Features

- Two Bedrooms
- Private Large Garden
- One Bathroom
- Open Plan
- Excellent Condition
- Pimlico Station



Lupus Street, London, SW1V

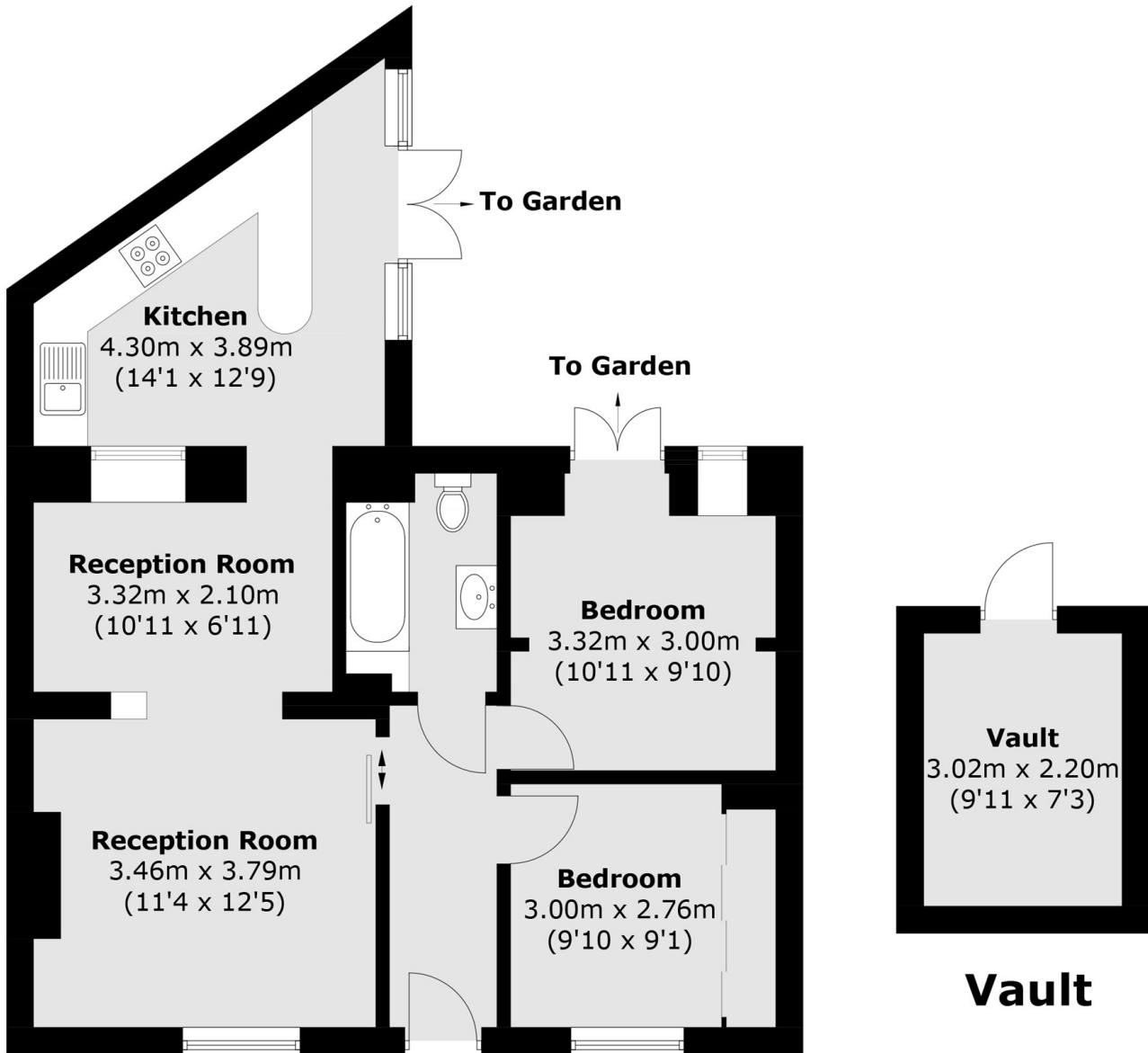

Lower Ground Floor

Total area (approx.): 62.9 sq. m (677.0 sq. ft)

Vault: 6.8 sq. m (73.2 sq. ft)