

Tel: 01923 677755
Fax: 01923 680729

www.claytons.co.uk

Claytons 



LEMONFIELD DRIVE, WATFORD - £450,000
3 Bedroom Mid Terraced House



Situated in a sought-after residential area of North Watford, this attractive three-bedroom mid-terraced family home offers well-balanced accommodation throughout and is ideally suited to first-time buyers, growing families, or those looking to upsize.

The property is entered via a welcoming hallway which leads through to a bright and spacious reception room, providing an excellent space for both everyday living and entertaining. To the rear, the kitchen enjoys views over the garden and offers ample storage and worktop space, creating a practical and functional heart of the home.

On the first floor, there are three well-proportioned bedrooms, including two generous double rooms and a comfortable single bedroom, all complemented by a family bathroom.

Outside, the property benefits from a private rear garden, providing a pleasant outdoor space for relaxation, children's play, or al fresco dining during the warmer months.

- Three Bedrooms
- Downstairs W/C
- Utility Area
- Garage En-Bloc
- No Upper Chain
- Rear Extension
- Freehold
- Close To Schools (Including Parmiters)

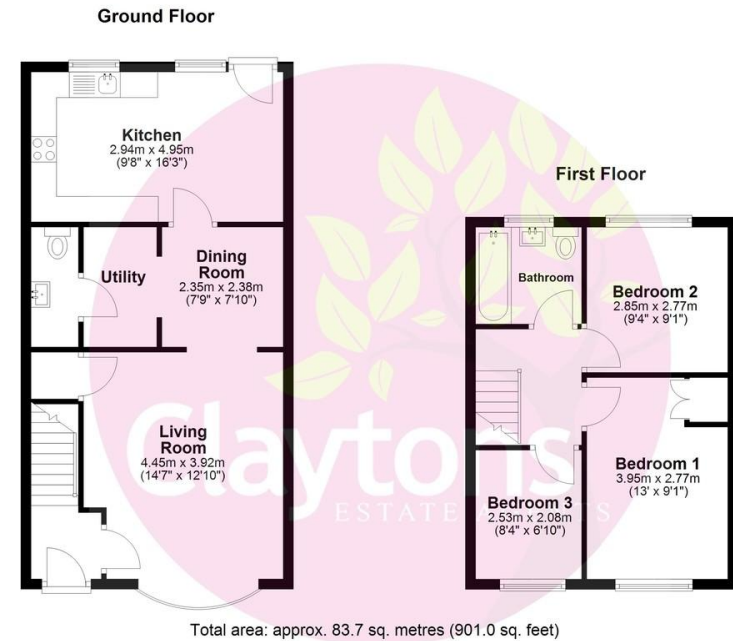

 VIEWING BY APPOINTMENT THROUGH CLAYTONS 01923 677755

FREE VALUATIONS & MARKETING ADVICE

Can we assist you in the sale of your property? If your home is situated within the catchment area of one of our sales offices we would be pleased to offer you a free valuation and market appraisal, a service which we provide without obligation. Competitive fees are always available for both sole and multiple agency. Please contact David Clayton on 01923 677755.

NB 1) We have not tested any appliances and/or services mentioned in these property particulars and do not intend to imply they are in full working order. Photographs are for illustrative purposes only and may show items that are not included in the sale of this property. 2) Due to Money Laundering Regulations 2003 we will ask all prospective purchasers for identification. 3) Buyers should seek verification from their solicitor about the legal title of this property.

These particulars are intended only to give fair description of the property, as a guide to prospective buyers. Accordingly, a) their accuracy is not guaranteed and neither Clayton's nor the Vendor(s) accept any liability in respect of their contents; b) they do not constitute an offer or contract of sale, and c) any prospective purchaser should satisfy themselves by inspection or otherwise as to the correctness of any statements or information on these particulars.

Clayton's & Hayes Ltd • Registered in England No. 2655243 • Registered Office: 4 Garston Park Parade, Garston, Watford, Herts WD25 9LQ • vat No. 579331903

See all our properties at www.claytons.co.uk

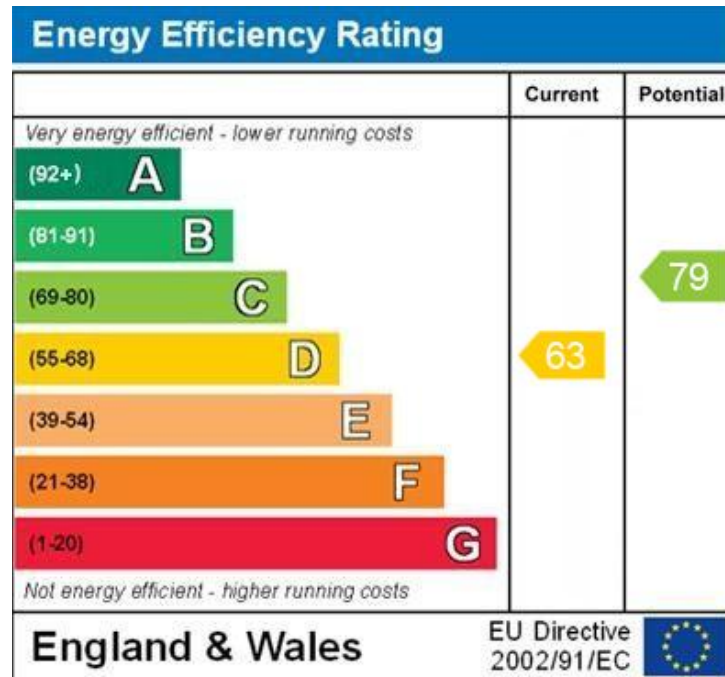

WWW.EPC4U.COM