

for sale

offers in excess of **£150,000**



Waveney Hemel Hempstead HP2 6DJ

One bedroom apartment, well-presented throughout. Great sized lounge and bedroom, modern family bathroom and kitchen, hallway with large storage cupboards. Gas central heating and double glazing. Close to local shops, schools and transport links. The ideal first time buy or investment! Call now!

Waveney Hemel Hempstead HP2 6DJ

Communal Entrance

Door to front with security entry system and stairs to all floors.

Entrance Hall

Door to front with intercom, three built in cupboards and radiator

Lounge

Double glazed window, TV point and radiator.

Kitchen

Fitted with wall and base units with work surfaces to compliment, sink/drainers with splashback, gas electric oven and hob, plumbing or washing machine, central heating boiler and double glazed window.

Bedroom

Double glazed window and radiator.

Bathroom





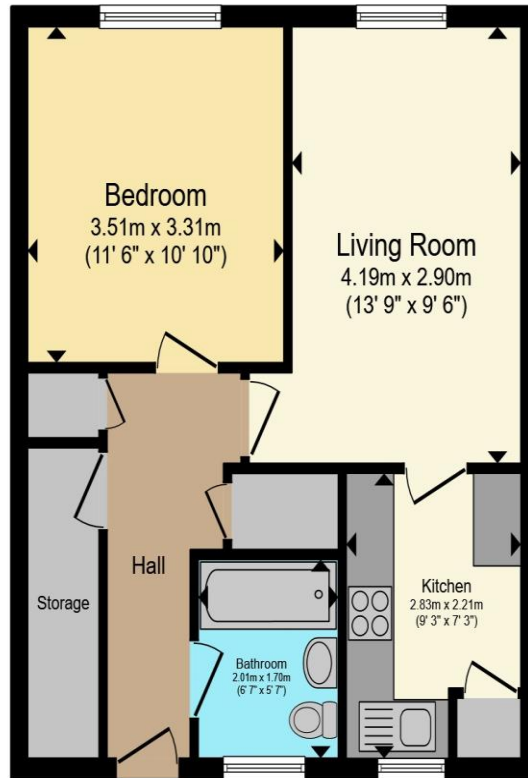

Total floor area 46.7 m² (503 sq.ft.) approx

This floor plan is for illustrative purposes only. It is not drawn to scale. Any measurements, floor areas (including any total floor area), openings and orientation are approximate. No details are guaranteed, they cannot be relied upon for any purpose and they do not form part of any agreement. No liability is taken for any error, omission or misstatement. A party must rely upon its own inspection(s). Powered by www.propertybox.io



To view this property please contact Connells on

T 01442 216 633
E hemelhempstead@connells.co.uk

45 Marlowes
 HEMEL HEMPSTEAD HP1 1LD

Property Ref: HEM312721 - 0004

Tenure:Leasehold EPC Rating: C

Council Tax Band: B Service Charge: 500.00

Ground Rent: 10.00

view this property online
connells.co.uk/Property/HEM312721

This is a Leasehold property with details as follows; Term of Lease 125 years from 24 Jun 1985. Should you require further information please contact the branch. Please Note additional fees could be incurred for items such as Leasehold packs.

1. MONEY LAUNDERING REGULATIONS Intending purchasers will be asked to produce identification documentation at a later stage and we would ask for your co-operation in order that there will be no delay in agreeing the sale. 2. These particulars do not constitute part or all of an offer or contract. 3. The measurements indicated are supplied for guidance only and as such must be considered incorrect. Potential buyers are advised to recheck measurements before committing to any expense. 4. We have not tested any apparatus, equipment, fixtures, fittings or services and it is in the buyers interest to check the working condition of any appliances.

Connells Residential is registered in England and Wales under company number 1489613, Registered Office is Cumbria House, 16-20 Hockliffe Street, Leighton Buzzard, Bedfordshire, LU7 1GN. VAT Registration Number is 500 2481 05.

