

## Hollyfield Road, Sutton Coldfield, B75

£125,000

2 1 1



Please Quote Ref TH0310 For All Enquiries - Well presented two bedroom top floor retirement apartment (644 Sq.Ft) for those over 60, with attractive communal gardens and secure entry, ideally located close to local shops and amenities. Well maintained with modern interiors throughout, the property offers bright and spacious self-contained living space, with the added benefit of welcoming communal areas including a residents lounge, kitchen and laundry. Further features include a generous reception room, separate well equipped kitchen, electric heating, double glazing, lift service, Appello call system and camera entry system, inbuilt storage, and no onward chain.



## Key Features

- Please Quote Ref TH0310 For All Enquiries
- Well Presented Two Bedroom Top Floor Retirement Flat (644 Sq.Ft)
- Popular Location on Outskirts of Sutton Coldfield
- Modern Development for Those over 60
- Bright, Well Planned Accommodation
- Residents Lounge, Kitchen and Laundry
- Secure Entry and Call System
- Communal Gardens
- Lift Service
- Close to Local Amenities

Floorplan of Apartment 23, Owen Court 2-12, Hollyfield Road,  
Sutton Coldfield, West Midlands, B75 7SG

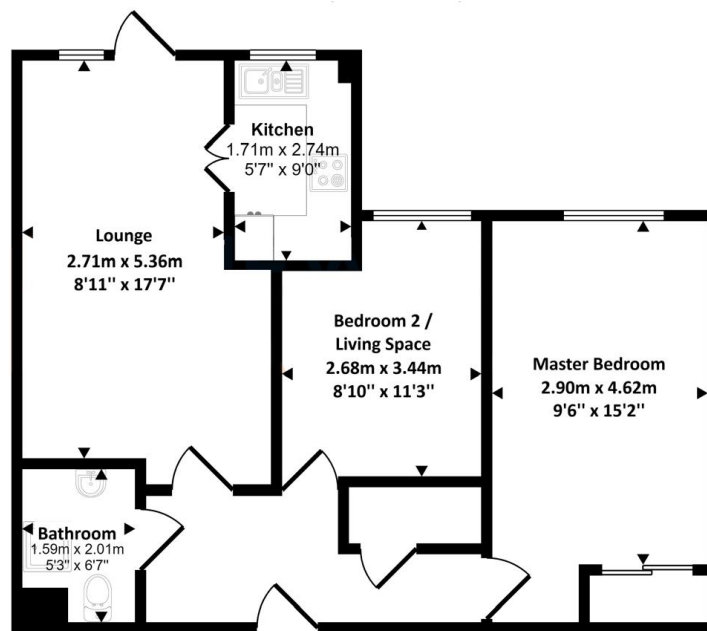

Approx Gross Internal Area  
60 sq m / 644 sq ft

This floor plan is provided for illustrative purposes only and is not drawn to scale. All measurements of rooms, doors, windows, and other features are approximate, and no liability is accepted for any inaccuracies, omissions, or misstatements. Fixtures and fittings shown, including bathroom suites, are for guidance only and may differ from the actual items.

