



8 Lushington House, Vicarage Fields, Walton-on-Thames, Surrey, KT12 2EP

£1400pcm + Initial deposit



Lushington House, Walton on Thames, KT12

Approximate Area = 679 sq ft / 63.0 sq m

For Identification Only - Not to scale

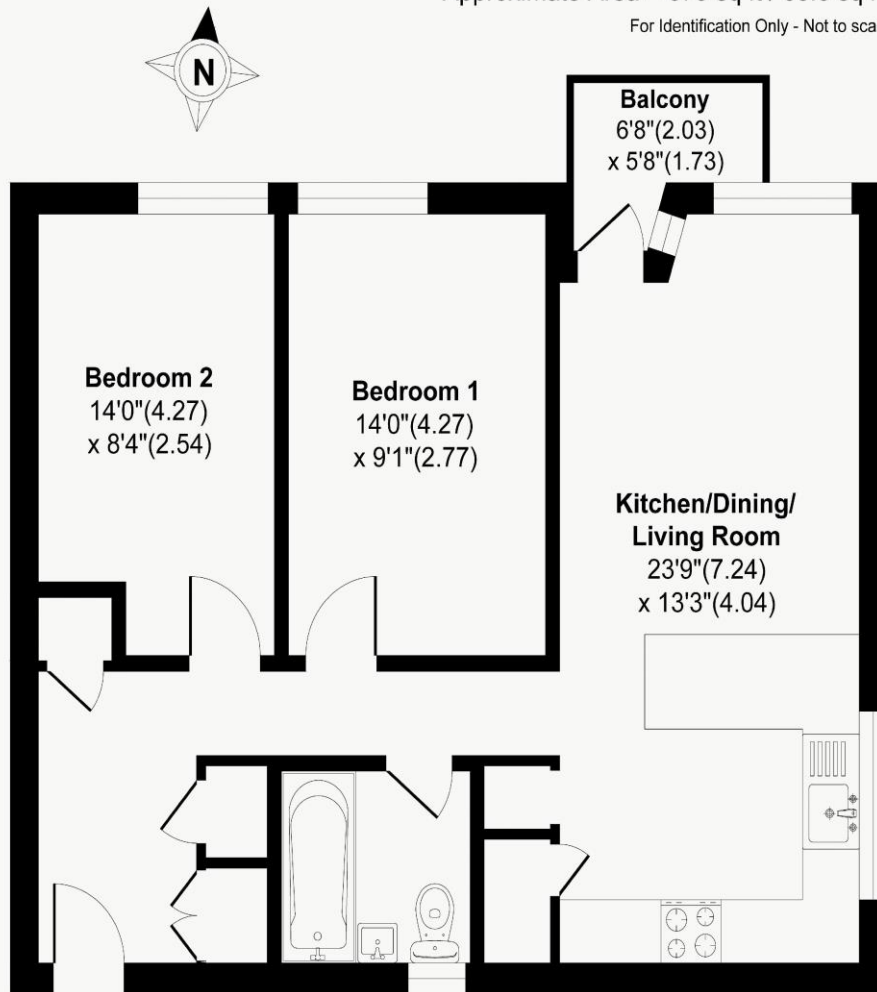

Second Floor

Floor plan Produced in accordance with RICS Property Measurement 2nd Edition, Incorporating International Property Measurement Standards (IPMS2 Residential). Produced for James Neave Estate Agents.



A spacious two double bedroom third-floor flat, ideally situated in a convenient location close to schools, local shops, and the River Thames. This well-proportioned property offers generous living accommodation, featuring two double bedrooms and a bright open-plan kitchen/living area with access to a private balcony. The building benefits from a secure entry system and lift access for added convenience. Available unfurnished, now. EPC Rating D.



AGENTS NOTES: These details do not constitute any part of an offer or contract. In issuing them we do not have any authority to give any warranty or representation whatsoever in respect of this property. These details are provided without any responsibility on our part or the part of the vendors. No statements in these details are to be relied upon as representations of fact and purchasers should satisfy themselves by inspection or otherwise as to the accuracy of the statements contained therein.

Equipment: We have not tested the equipment or central heating system mentioned in these particulars and purchasers are advised to satisfy themselves as to their working order and condition.

Measurements: Great care is taken when measuring but measurements should not be relied upon for ordering carpets, equipment, etc.