



Regal Helmsworth





# Regal Helmsworth

, Golden Cap Holiday Park, Chideock, DT6 6JX

Jurassic Coast 0.25 miles. Chideock 0.75 miles. Bridport 4 miles.

A new contemporary holiday home in a beautiful setting just back from Seatown and the Jurassic Coast.

- Luxury new holiday home
- 2 Bedrooms
- Well appointed
- Beautiful parkland setting
- Pitch fees - £6,024 per annum
- 40ft x 13ft
- 2 Bathrooms
- Decking
- 5 Minutes' walk to Seatown/the beach
- Expiry 2044

Guide Price £69,995

## AGENT'S NOTE

The property is for second home/holiday use only and cannot be used as your main residence. No lettings are allowed.

## THE PROPERTY

An excellent opportunity to purchase a luxury new holiday home in a beautiful setting at Golden Cap Holiday Park, just back from Seatown and the stunning Jurassic Coast. Regal Helmsworth offers many excellent impressive features which include:

- Contemporary and spacious holiday home
- Well appointed throughout
- Open plan lounge/kitchen
- Gas-fired central heating
- Double glazed
- Master bedroom with en-suite shower room
- Twin bedroom
- Shower room





- Walk-in wardrobe
- Glass fronted decking and allocated parking
- Beautiful landscaped grounds
- Leisure facilities available at nearby sister parks including swimming pool, bar, restaurant etc.
- Family & dog friendly park
- Season – Length 46 weeks (9 months)

## TENURE

New 20 year licence with 9 month season. Annual pitch fee to cover upkeep of communal areas, rates, water charges and VAT.

## SURROUNDING AREAS

Golden Cap Holiday Park is a small, intimate and peaceful, holiday park just back from the Jurassic Coast and Seatown, with its lovely bathing beaches, public house and access to clifftop walks. The village of Chideock is very nearby offering local facilities and a regular bus service. The thriving market town of Bridport is also very nearby with excellent facilities. The coastal resort of West Bay and the historic coastal town of Lyme Regis are also within easy reach.

## SERVICES

Mains electricity, water and drainage. Gas central heating.

## VIEWINGS

Strictly by appointment with Stags Bridport.

## DIRECTIONS

From Bridport proceed west along the A35 to Chideock. On reaching the centre turn left, signed Seatown, and then take the 1st left onto Mill Lane. Golden Cap Holiday Park is after about half a mile on the right.



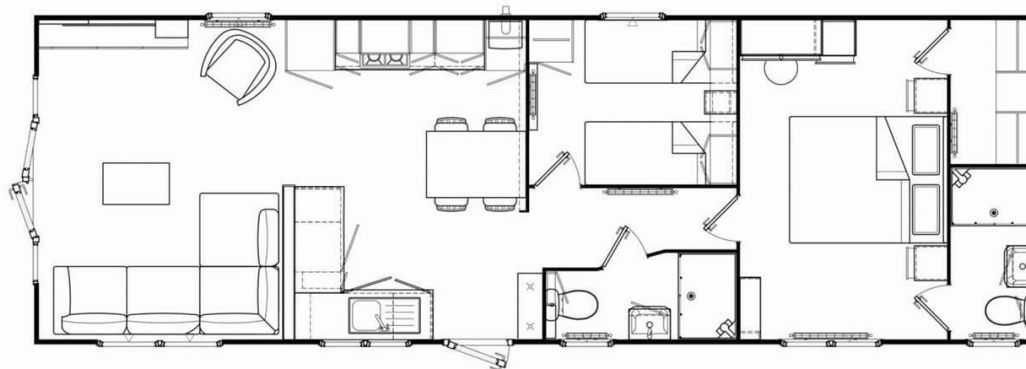

IMPORTANT: Stags gives notice that: 1. These particulars are a general guide to the description of the property and are not to be relied upon for any purpose. 2. These particulars do not constitute part of an offer or contract. 3. We have not carried out a structural survey and the services, appliances and fittings have not been tested or assessed. Purchasers must satisfy themselves. 4. All photographs, measurements, floorplans and distances referred to are given as a guide only. 5. It should not be assumed that the property has all necessary planning, building regulation or other consents. 6. Whilst we have tried to describe the property as accurately as possible, if there is anything you have particular concerns over or sensitivities to, or would like further information about, please ask prior to arranging a viewing.



32 South Street, Bridport, Dorset, DT6 3NQ

[bridport@stags.co.uk](mailto:bridport@stags.co.uk)

01308 428000



@StagsProperty

Cornwall | Devon | Somerset | Dorset | London