



MANDRAKE ROAD, SW17

£1,275,000

- Victorian Family Terrace House
- 4 Large Double Bedrooms
- 2 Full Bathrooms + GF WC
- Generous Double Reception
- Extended Kitchen Diner
- South Facing Family Garden





ABOUT THE HOME

A charming and stylishly presented 4 double bedroom Victorian family home. It has been fully extended and modernised throughout, with a carefully considered layout to maximise the space. Internally the property offers a healthy 1,753 sq ft. The ground floor comprises a spacious double reception room with bespoke alcove storage, original fire surrounds, and a bay window with double-glazed windows. A ground floor WC. Oak flooring carries you through to the rear of the property, which features a fully extended kitchen diner. This area includes underfloor heating, a large island, integrated appliances, and bi-folding doors leading to a south-facing rear garden with mature planted borders, an Astroturf lawn, and a storage shed. Returning inside, the first floor has been reconfigured to offer a very large principal bedroom, a second double bedroom. The sleek family bathroom includes his-and-hers sinks, a freestanding bath, and a separate double shower. The converted 2nd floor offers 2 further double bedrooms that are well-proportioned and a second bathroom, which also features a freestanding bath and a separate double shower.





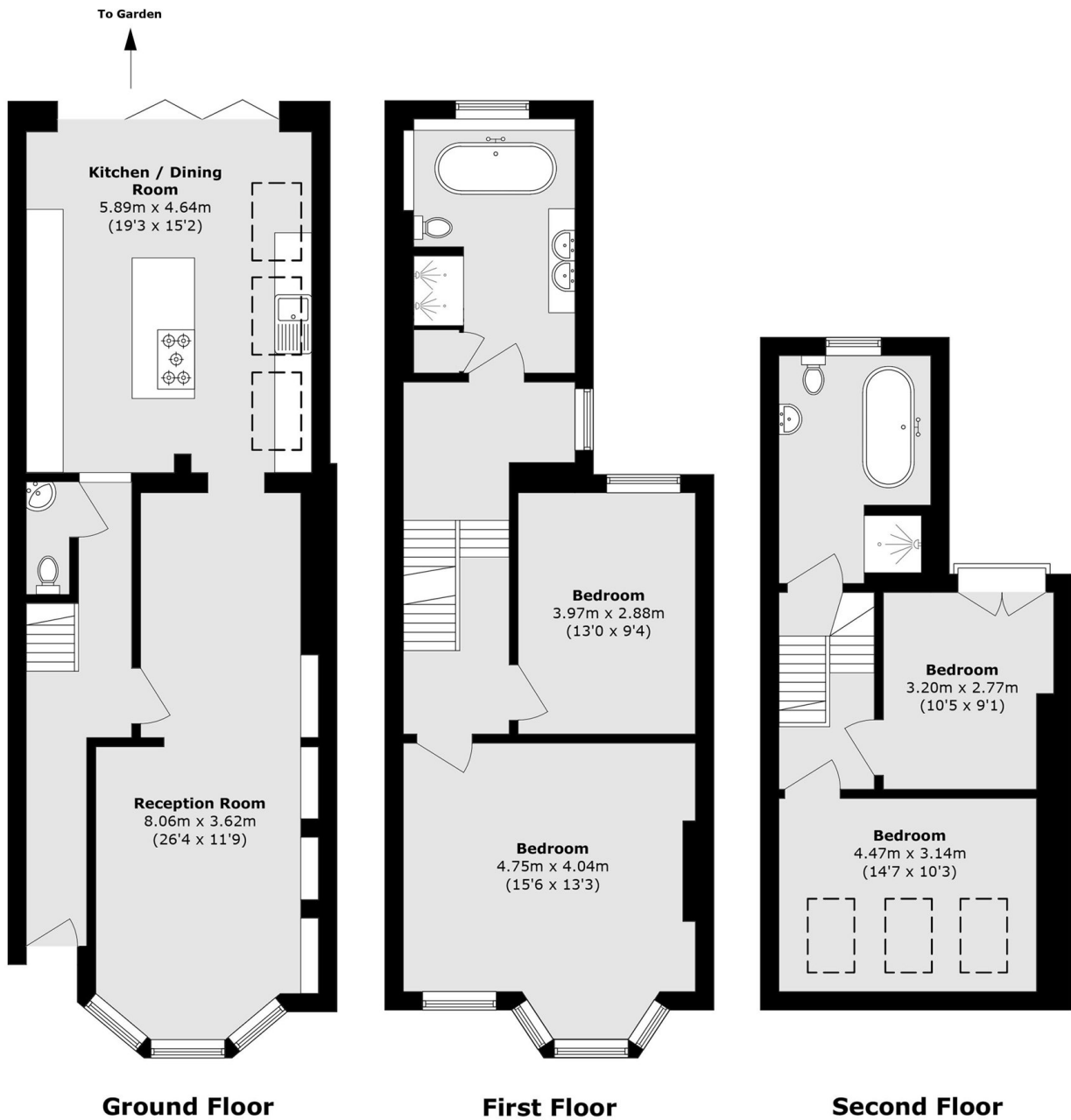

Total area (approx.): 162.9 sq. m (1753.4 sq. ft)

JACKSONS TOOTING

3 Upper Tooting Road, London,
SW17 7TS
Sales: 020 8487 3175
Lettings: 020 8487 3176

Energy Rating: We aim to make our particulars both accurate and reliable. However they are not guaranteed; nor do they form part of an offer or contract. If you require clarification on any points then please contact us, especially if you're traveling some distance to view. Please note that appliances and heating systems have not been tested and therefore no warranties can be given as to their good working order.