



## Queens Terrace

Isleworth, TW7

£500,000

A charming two bedroom period home on Queen's Terrace, brought to market for the first time in 17 years and dutifully cared for by the current owner. Offered to the market with no onward chain this delightful cottage comprises two double bedrooms, a cosy reception room with renovated fireplace and a generous eat-in kitchen diner with patio doors onto a beautifully landscaped south-facing garden. A utility room and an upstairs bathroom complete the accommodation. Clove Cottage is enviously located close to the river Thames, St Margaret's Station and Old Isleworth's bars, cafés, shops and green spaces. Further benefits include a recently installed Vailant eco-boiler (June 2023) and easy access to a semi boarded loft with pull down ladder and electricity.

- Beautiful Two Bedroom Cottage
- South Facing Garden
- Excellent Location - Moments from the River Thames and St Margarets Station
- No Onward Chain
- Upstairs Bathroom
- Utility Room



SCAN HERE  
FOR  
PROPERTY  
DETAILS



OAKHILL

## Queens Terrace, Isleworth, TW7 7DB

Approximate Gross Internal Area  
Main House 678 sq ft - 63 sq m

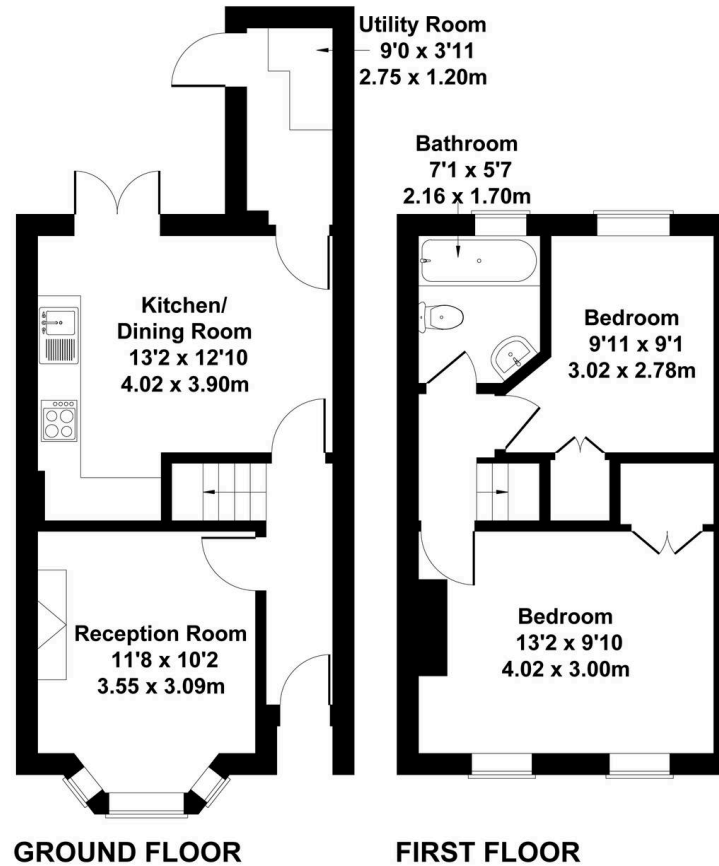

This floorplan is for guidance only and does not form part of an offer or contract.  
Buyers or tenants should verify all details through inspection, searches, and surveys.  
Measurements are approximate and should not be relied upon for valuation or transactions.  
Produced by Plan Portal.  
[www.evovelondon.co.uk](http://www.evovelondon.co.uk)