



Fordwych Road, NW2

£2,800

AVAILABLE TO LET Available to let: this bright and spacious two-bedroom garden flat on the tree-lined Fordwych Road offers 790 sq ft of well-laid-out accommodation, including a bay-fronted reception room, separate fitted kitchen, private garden, and off-street parking.

Ideally located close to West Hampstead and West End Lane's shops, cafés, bars, and restaurants, with excellent transport links via Kilburn Jubilee Line (Zone 2) and Overground stations.

- 2 bedroom Garden Flat
- Offering 790 sq ft of accommodation
- Private rear garden
- Kilburn (Jubilee-Zone 2)
- COUNCIL: Camden (D)
- Deposit: £2,884



020 8450 9377 - 020 8459 1133
rentals@cameronsstiff.co.uk

Fordwych Road, NW2

Approx Gross Internal Area = 73.4 sq m / 790 sq ft
For identification only - Not to scale

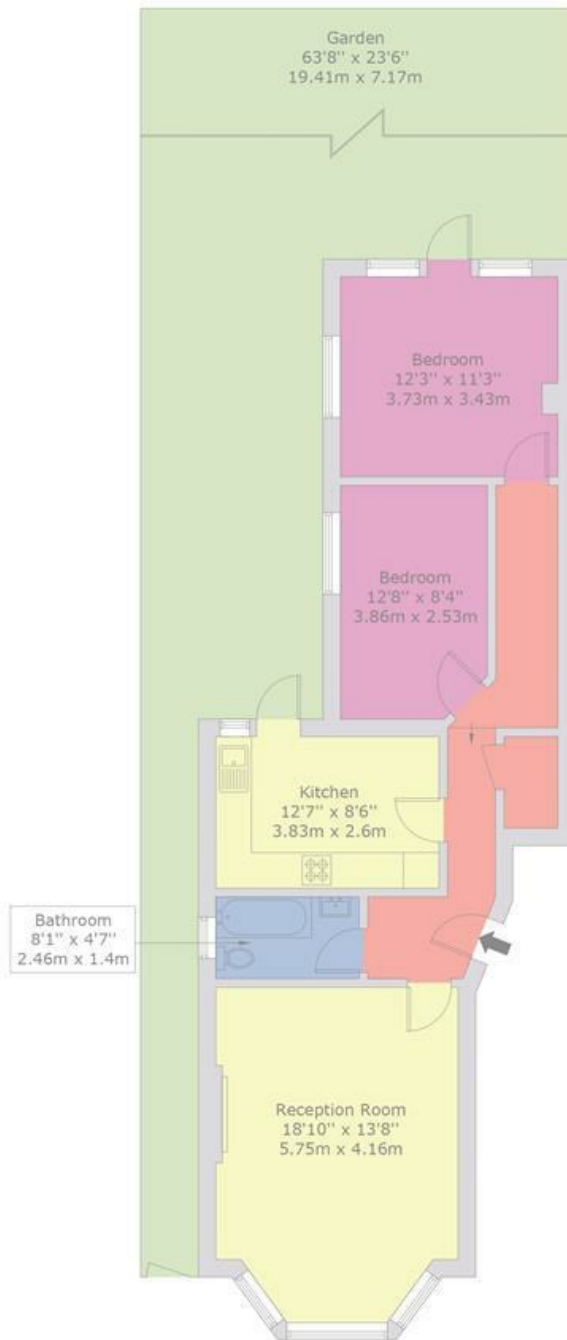

GROUND FLOOR



This floor plan is produced in accordance with RICS Property Measurement Standards incorporating International Property Measurement Standards (IPMS2 Residential). Maximum lengths and widths are represented on the floor plan. Produced for Cameron Stiff & Co. Copyright © BLEUPLAN

EPC: D
Ref: 19319349

