



Pratt Mews, NW1

TO LET - £2,100 Per Month

AVAILABLE TO LET 28TH MARCH 2026- Ideally located in the heart of Camden Town, this First-floor apartment offers a practical and spacious living arrangement for those looking to be in the center of the action. The layout features a functional open-plan kitchen and reception area that maximizes the available space, alongside two honest double bedrooms and a standard tiled bathroom suite. While the decor is simple and understated, the apartment's elevated position ensures plenty of natural light and provides a quiet retreat from the vibrant High Street just moments away.

The standout feature of this property is its exceptional location, situated just a five-minute walk from both Camden Town and Mornington Crescent stations (Northern Line- Zone 1). With Euston nearby and the endless variety of Camden's famous bars and amenities at your doorstep, it serves as a highly convenient base for city living. Available on a furnished or unfurnished basis, this is a straightforward, well-located home perfect for anyone who values proximity to transport and local culture above high-end finishes.



020 8450 9377

rentals@cameronsstiff.co.uk

cameronsstiff.co.uk



Pratt Mews, NW1

Approximate Area = 53.0 sq m / 570 sq ft

For Identification only - Not to Scale

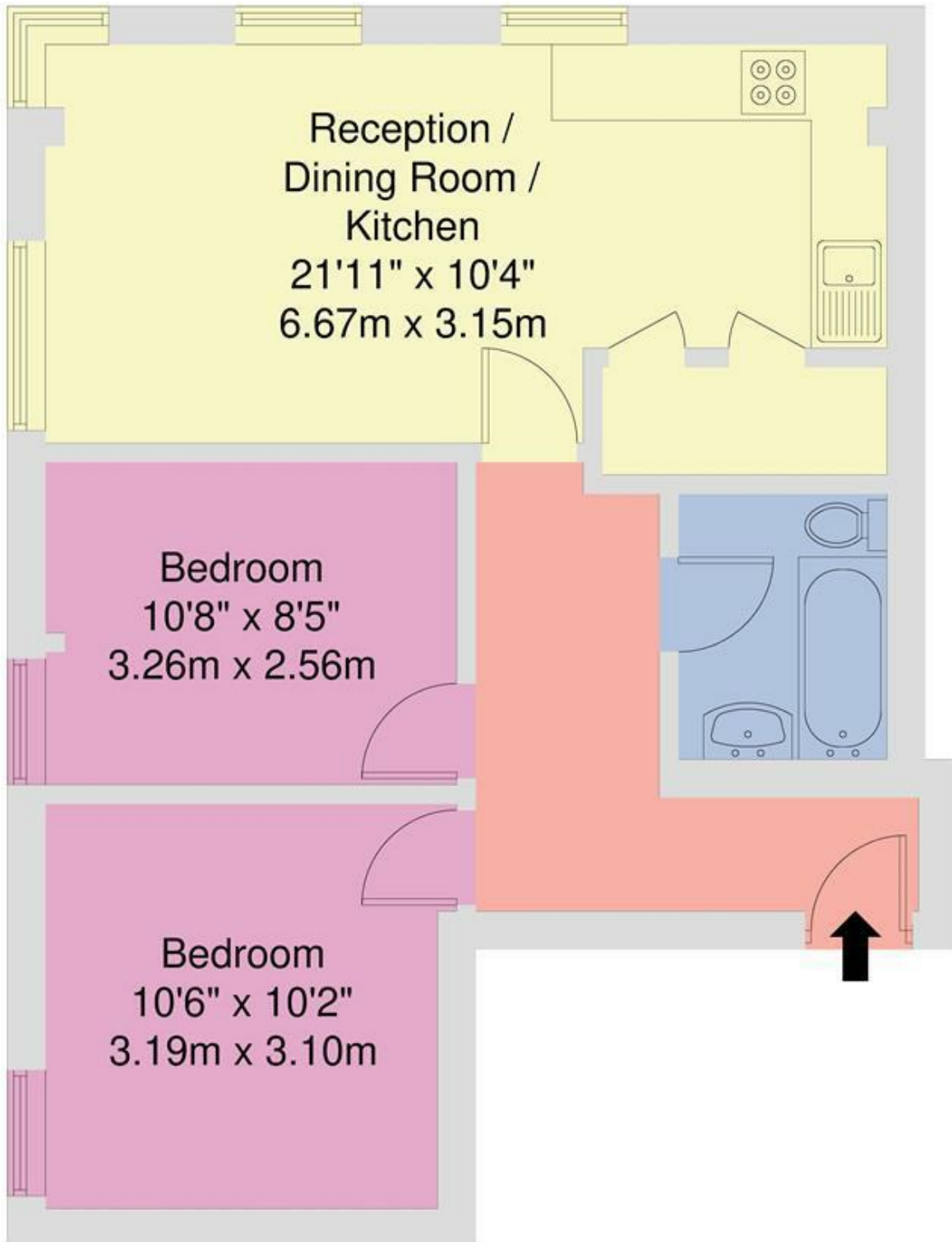

SECOND FLOOR

EPC: C

Ref: 19647241

Disclaimer : Floorplan measurements are approximate and are for illustrative purposes only. While we do not warrant the completeness, you or your advisors should conduct a careful, independent investigation of the property in person.

